



Table Mounted

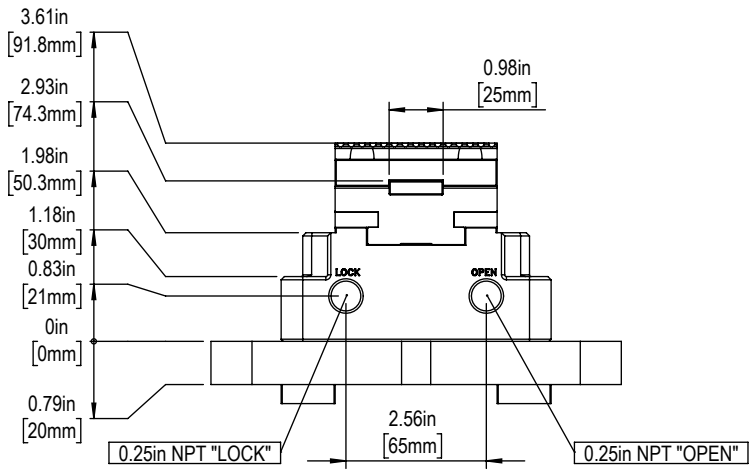
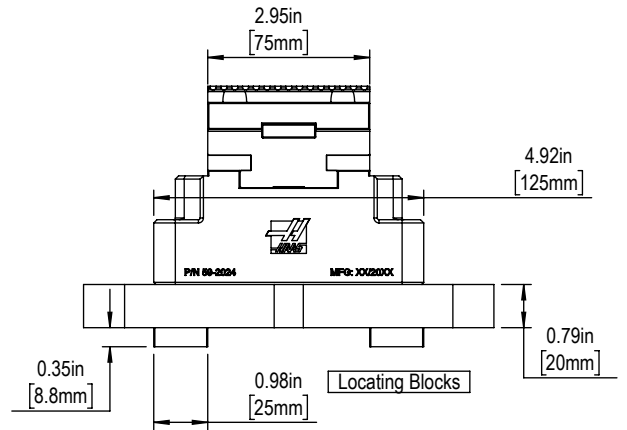
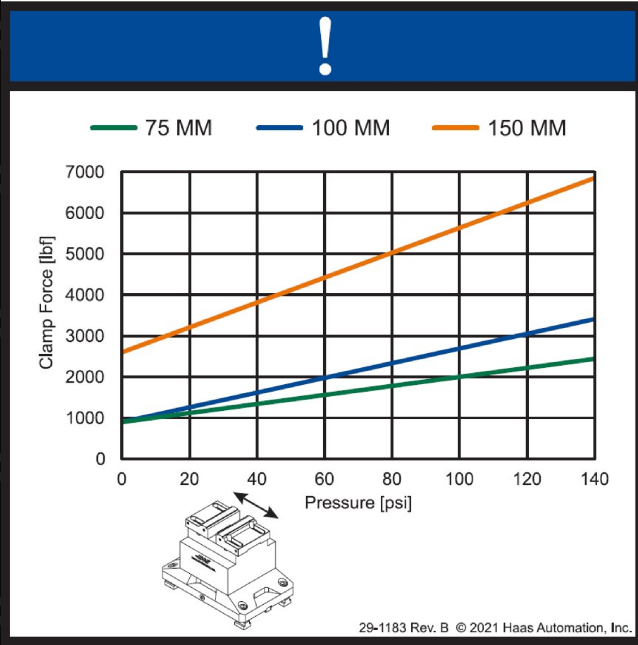
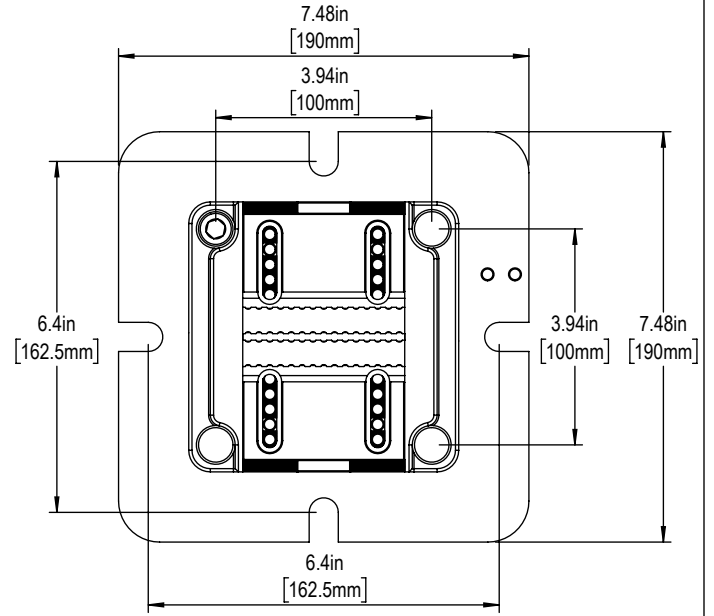
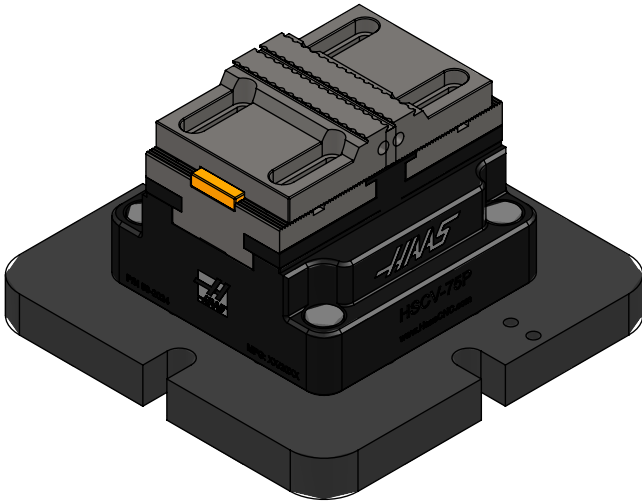
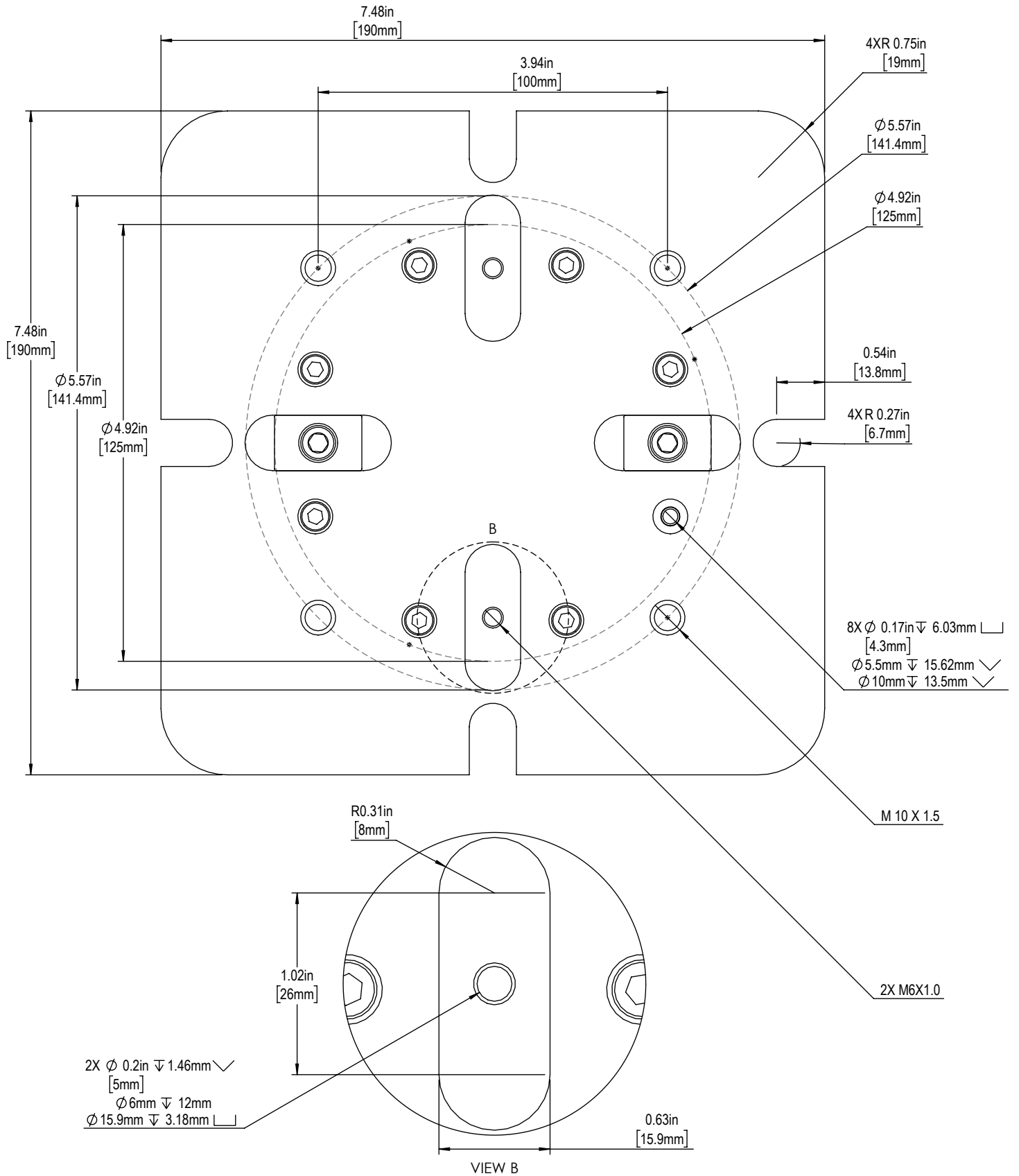
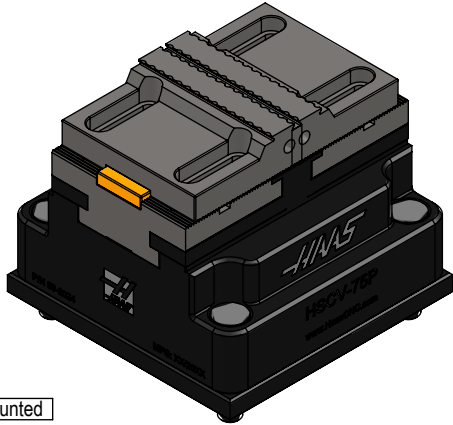



Table Mounted

**BOTTOM**





Rotary Mounted

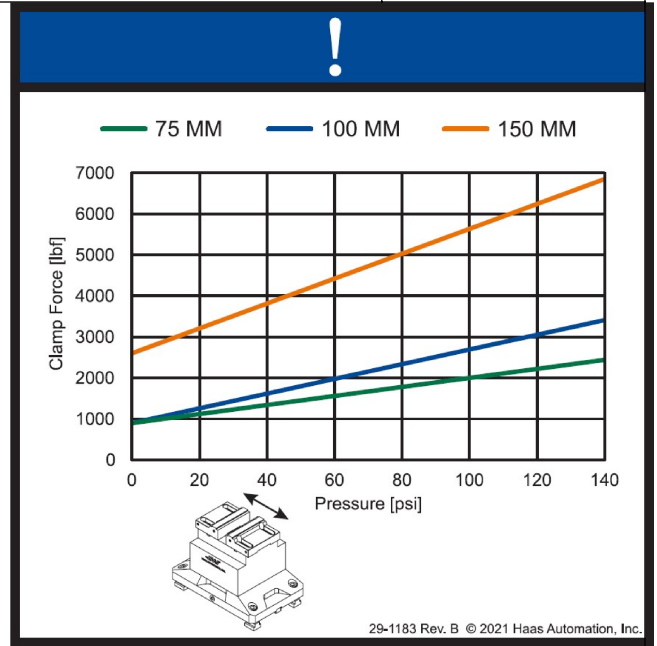

29-1183 Rev. B © 2021 Haas Automation, Inc.

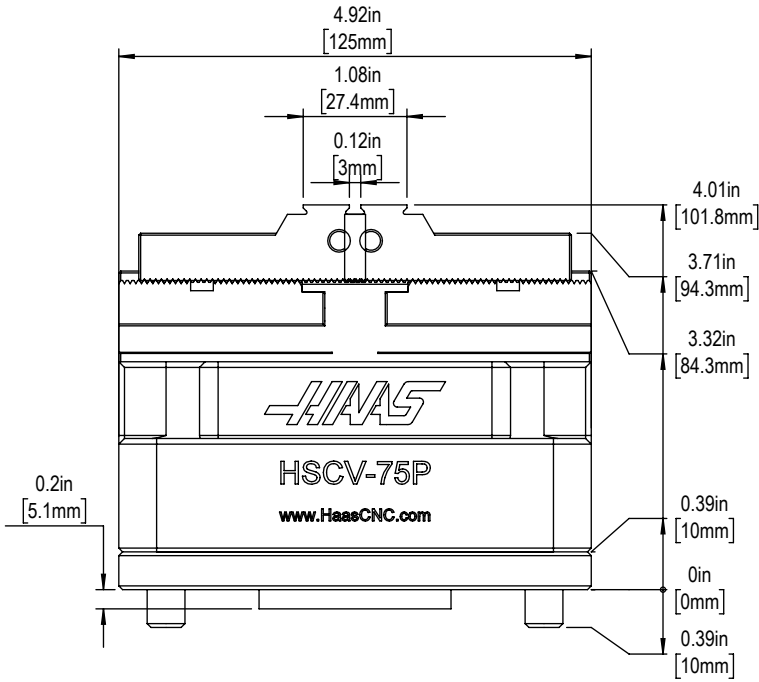

Top

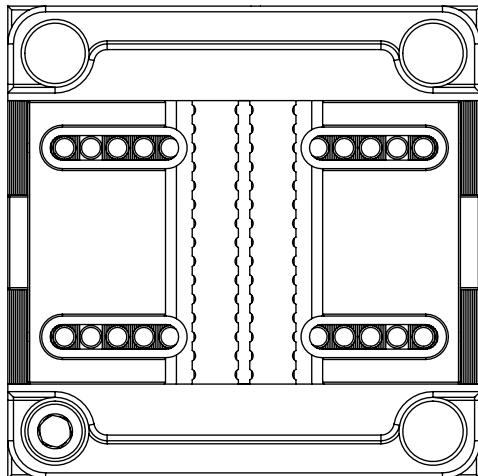
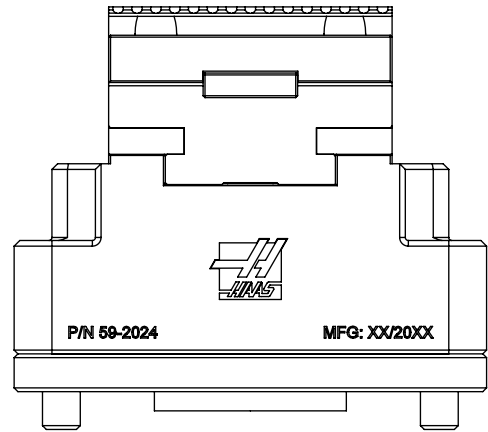



Rotary Mounted

**BOTTOM**

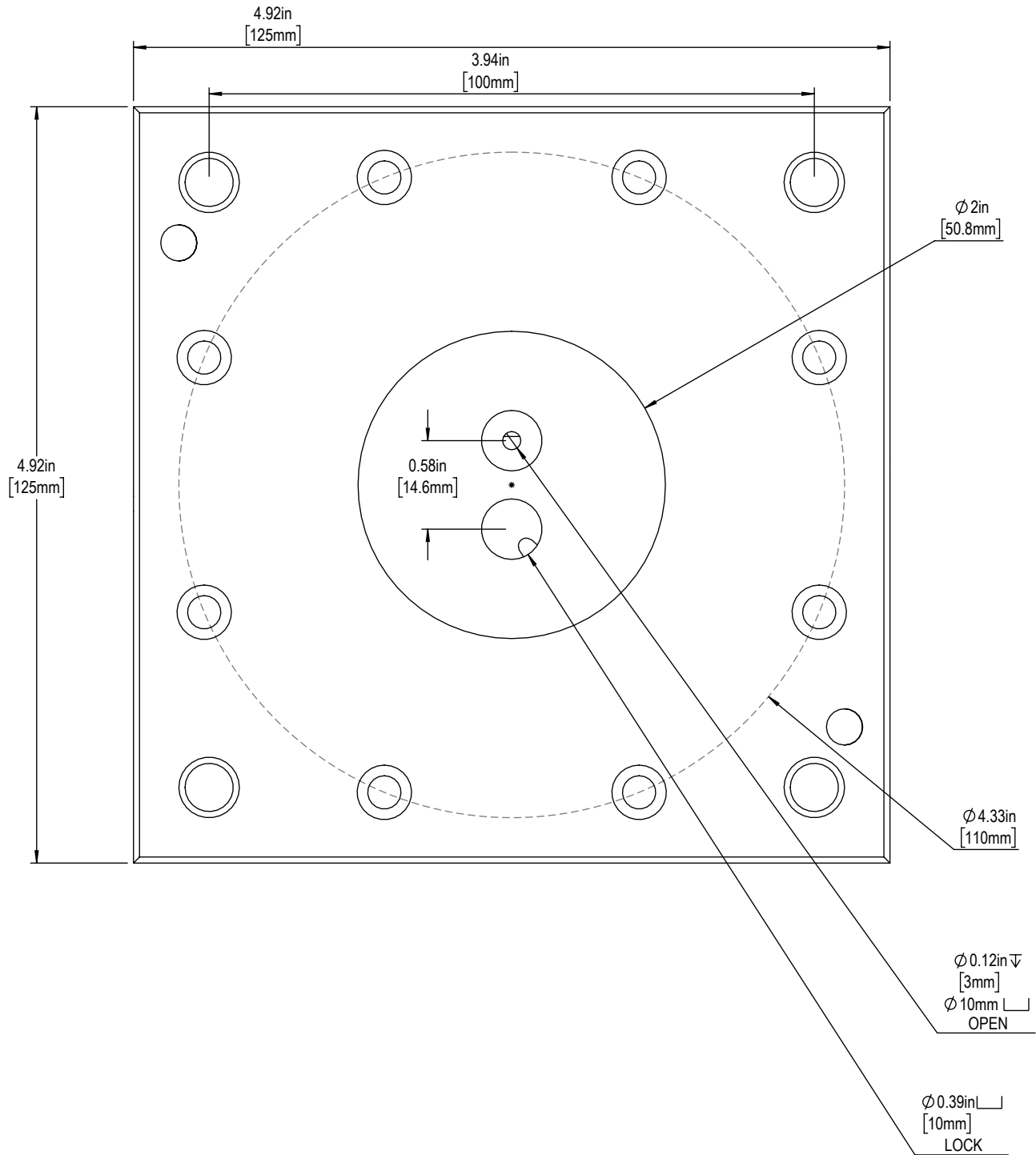

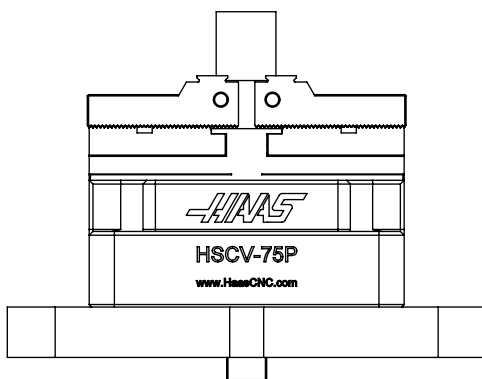
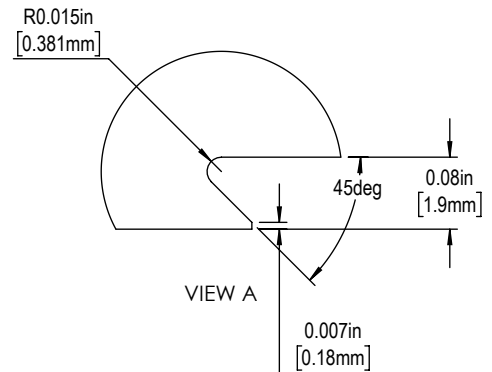
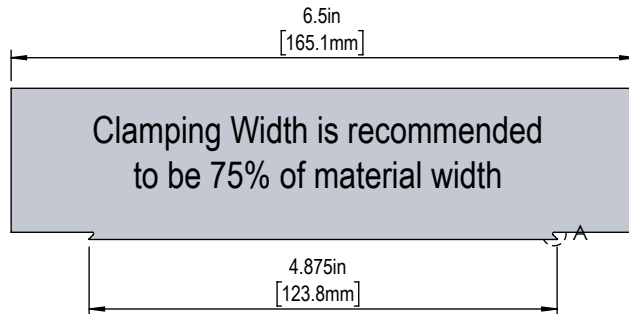

[A] Both Jaws Inward

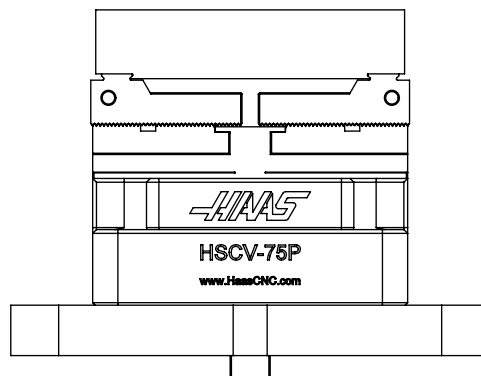

[B] Both Jaws Outward

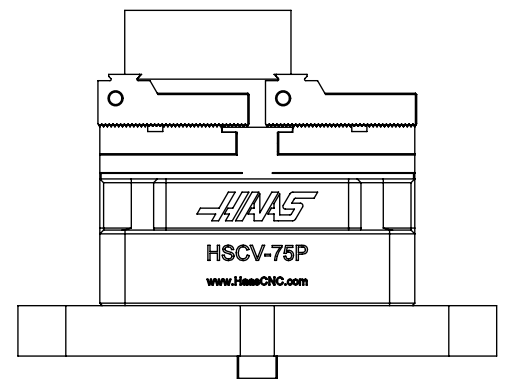

[C] One Jaws Inward, One Jaw Outward

**Note:**

1. Off centered clamping is not allowed. Workpiece must be centered or balanced on opposite side or damage will occur.
2. Jaw stroke = 2.5mm per side, 5mm total.
3. Vise Clamping Range:
  - [A] Both Jaws Inward 0.4 - 1.6in [10-40mm]
  - [B] Both Jaws Outward 3.9 - 6.7in [99-170mm]
  - [C] One Jaw Inward, One Jaw Outward 2.2 - 5.6in [56-142mm]

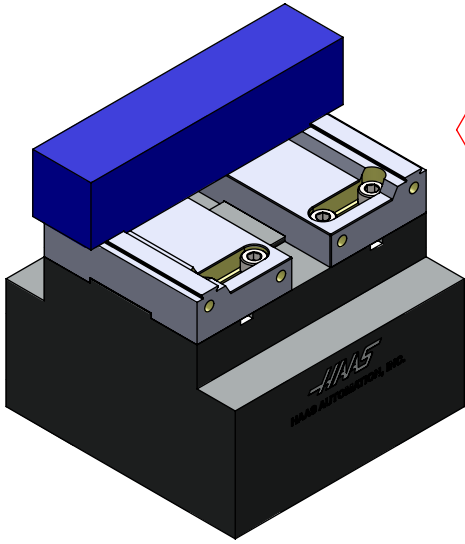

Incorrect

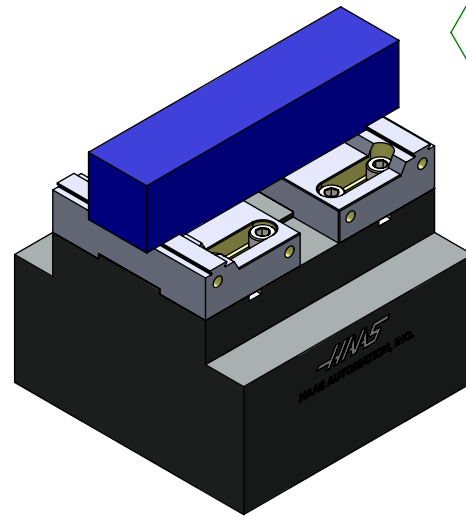

Correct

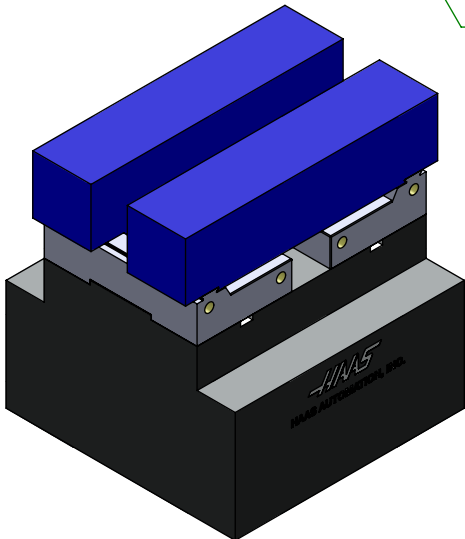

Correct

Warning: Off-centered clamping will result in damage to vise not covered under warranty

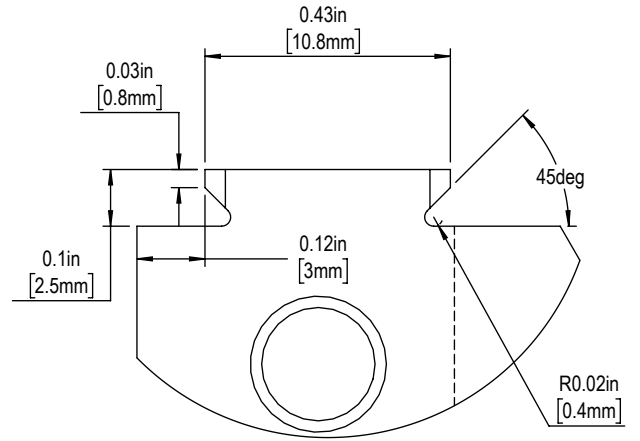
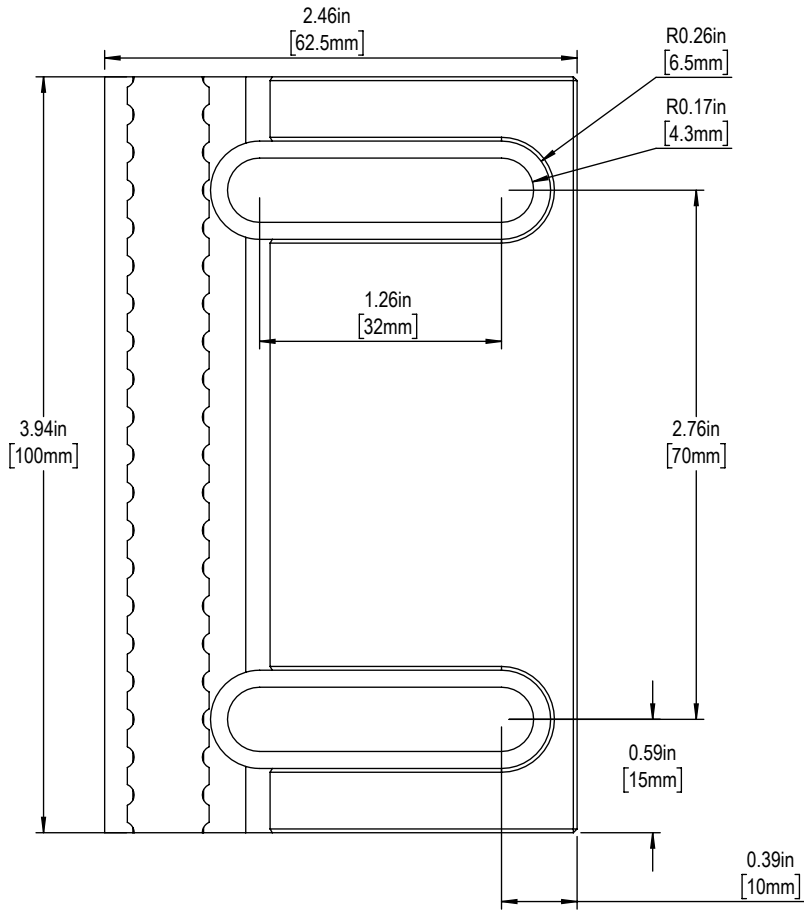

**DETAIL D**  
SCALE 3:1

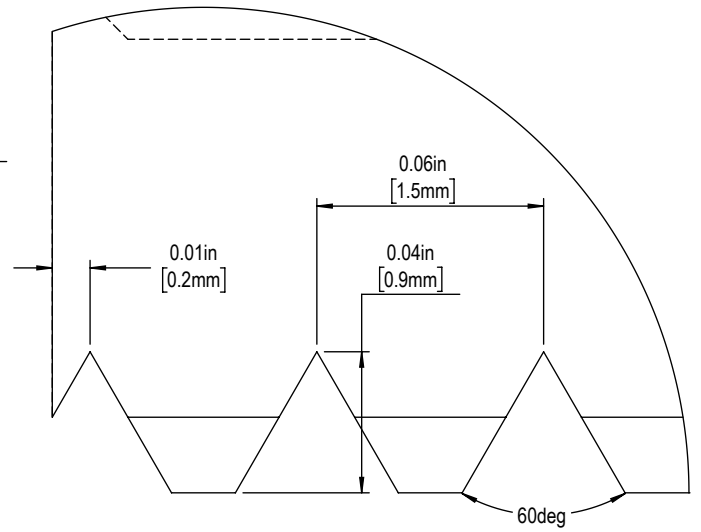
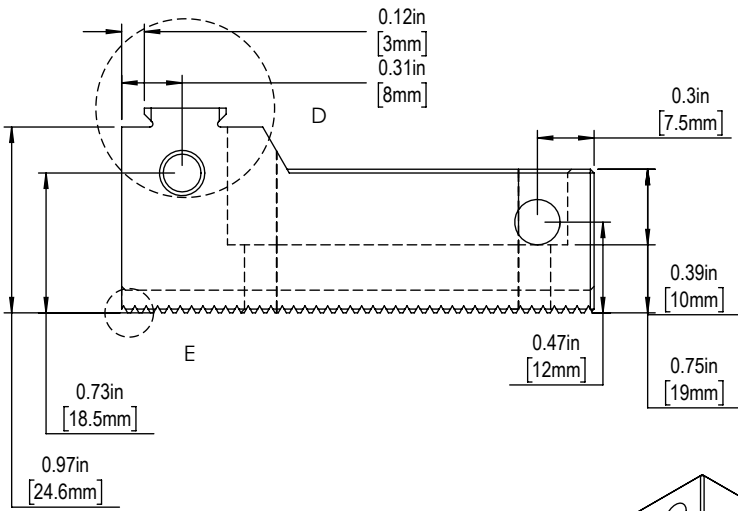

**DETAIL E**  
SCALE 20:1

