

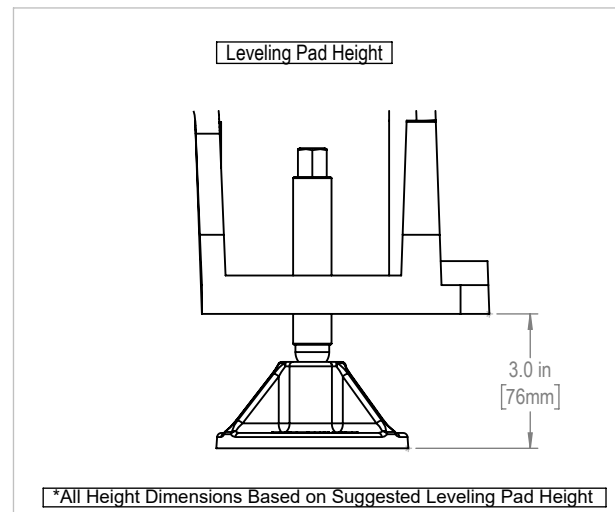

Installed Dimensions

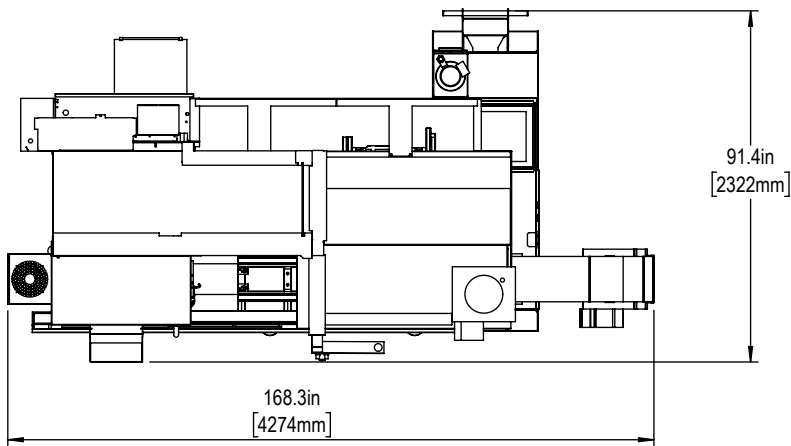

Shipping Dimensions

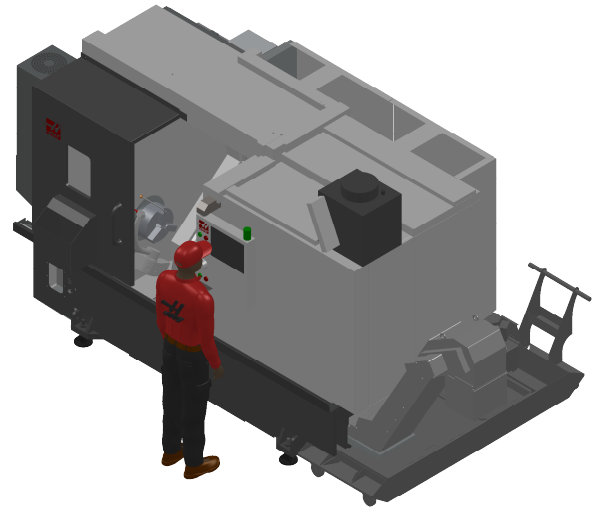
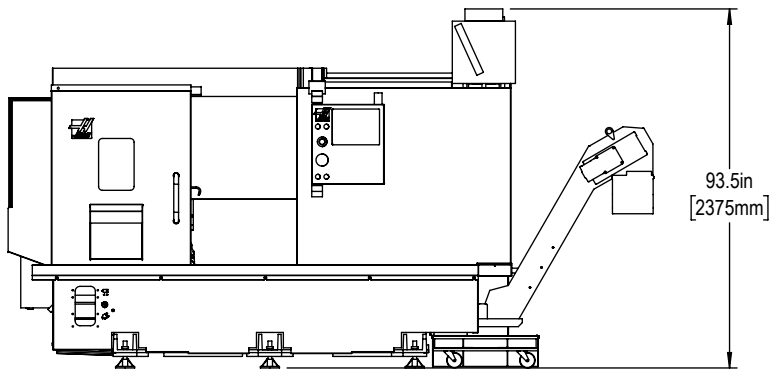
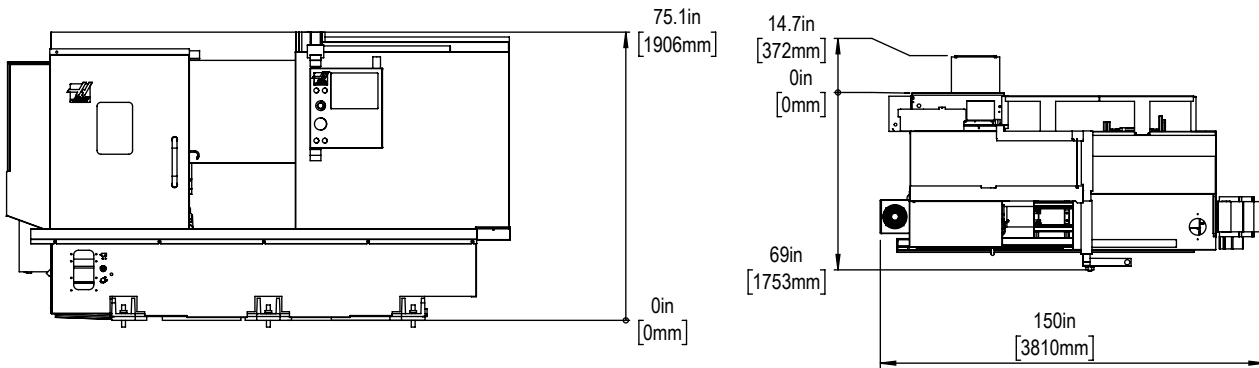

Air & Power

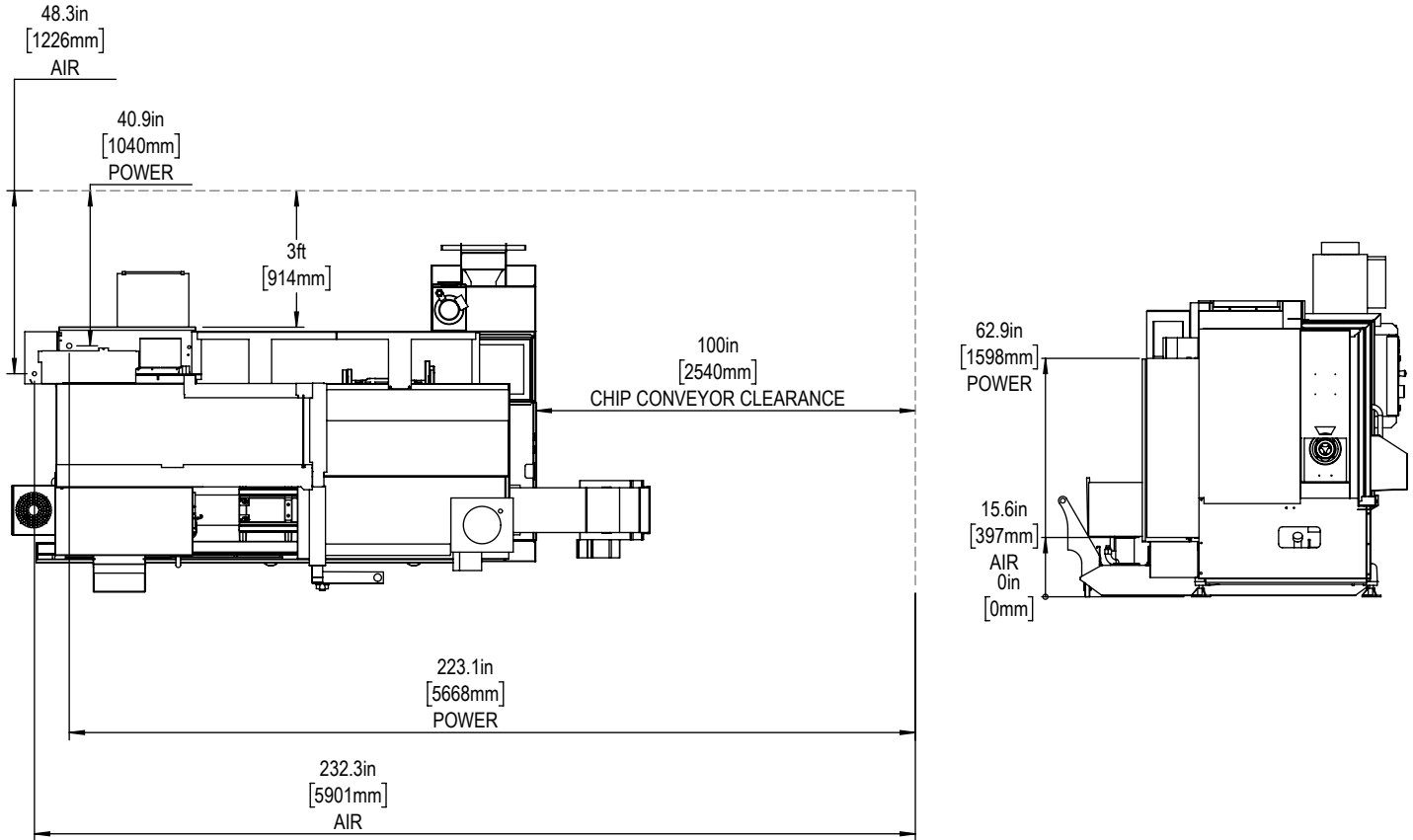

Note:
Machine must be placed on one continous concrete slab. Slab should extend 12in [305mm] beyond anchor holes in all directions

Anchor Pattern

Anchor Hole Detail
 Ø 1.0in[25mm]
 ▽ 2.0in[50mm]-
 ▽ 2.25in[57mm]

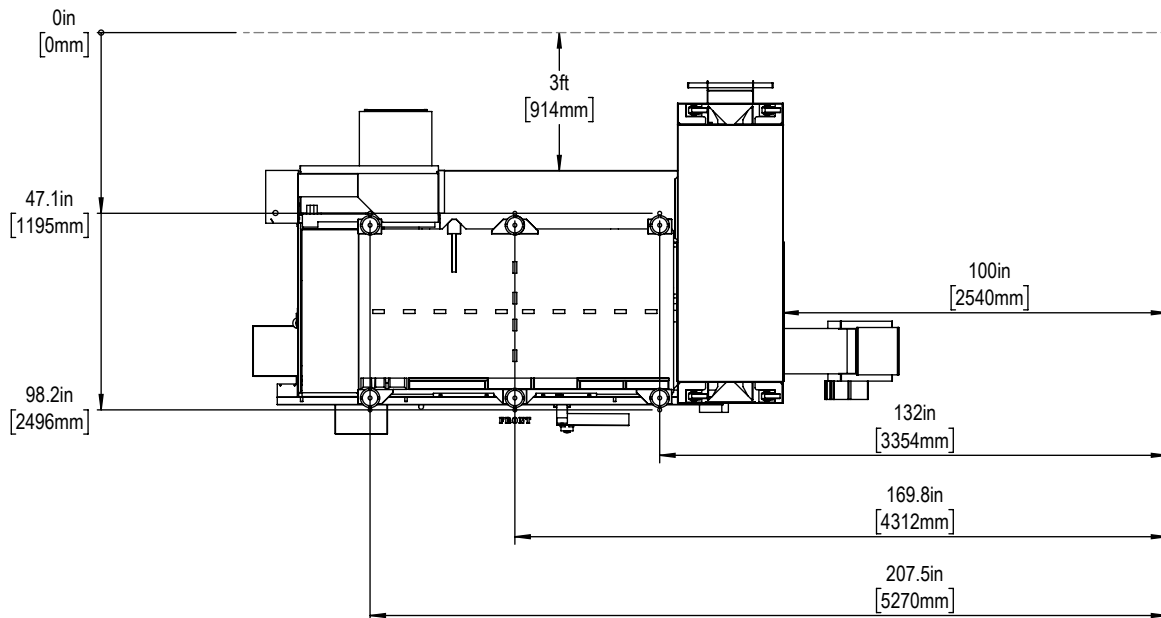

For precise locations and specifications please use template in Anchoring Kit found at Haascnc.com



Height Breakdown

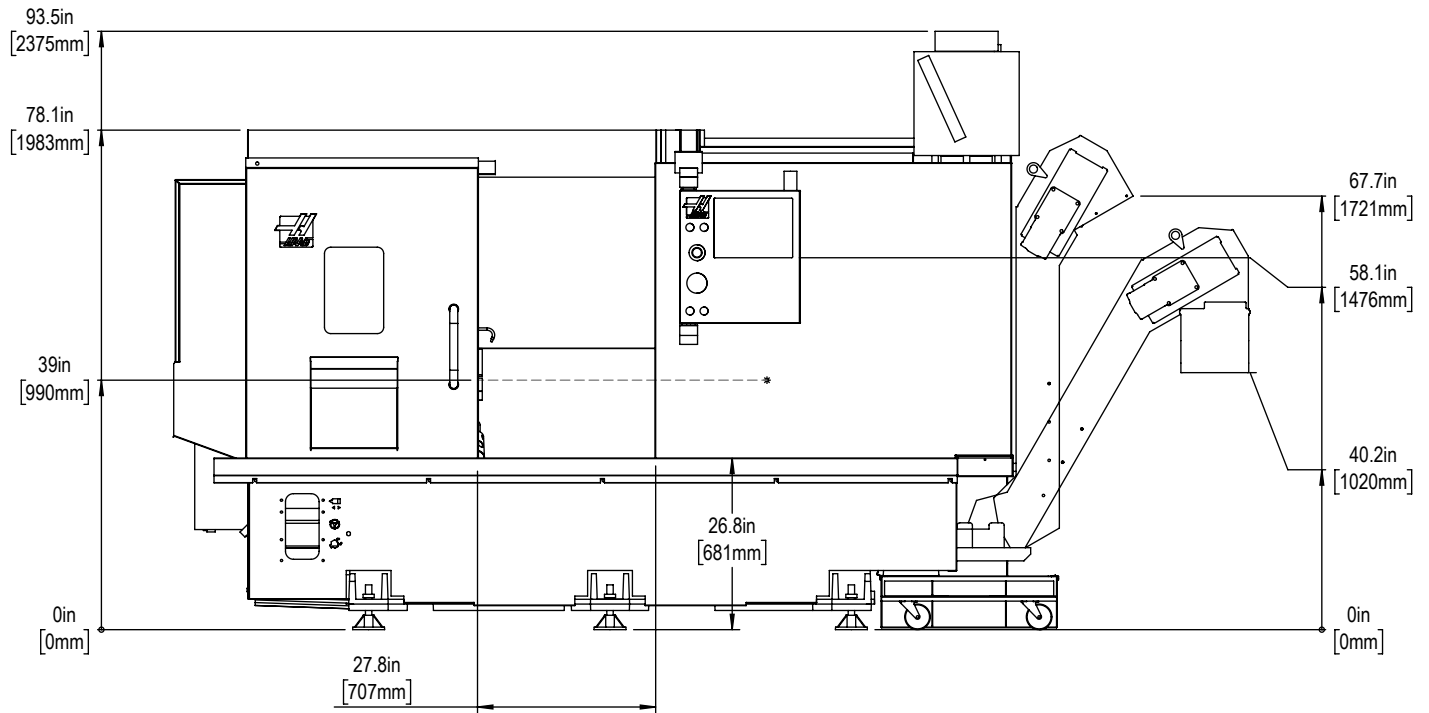

Width Breakdown

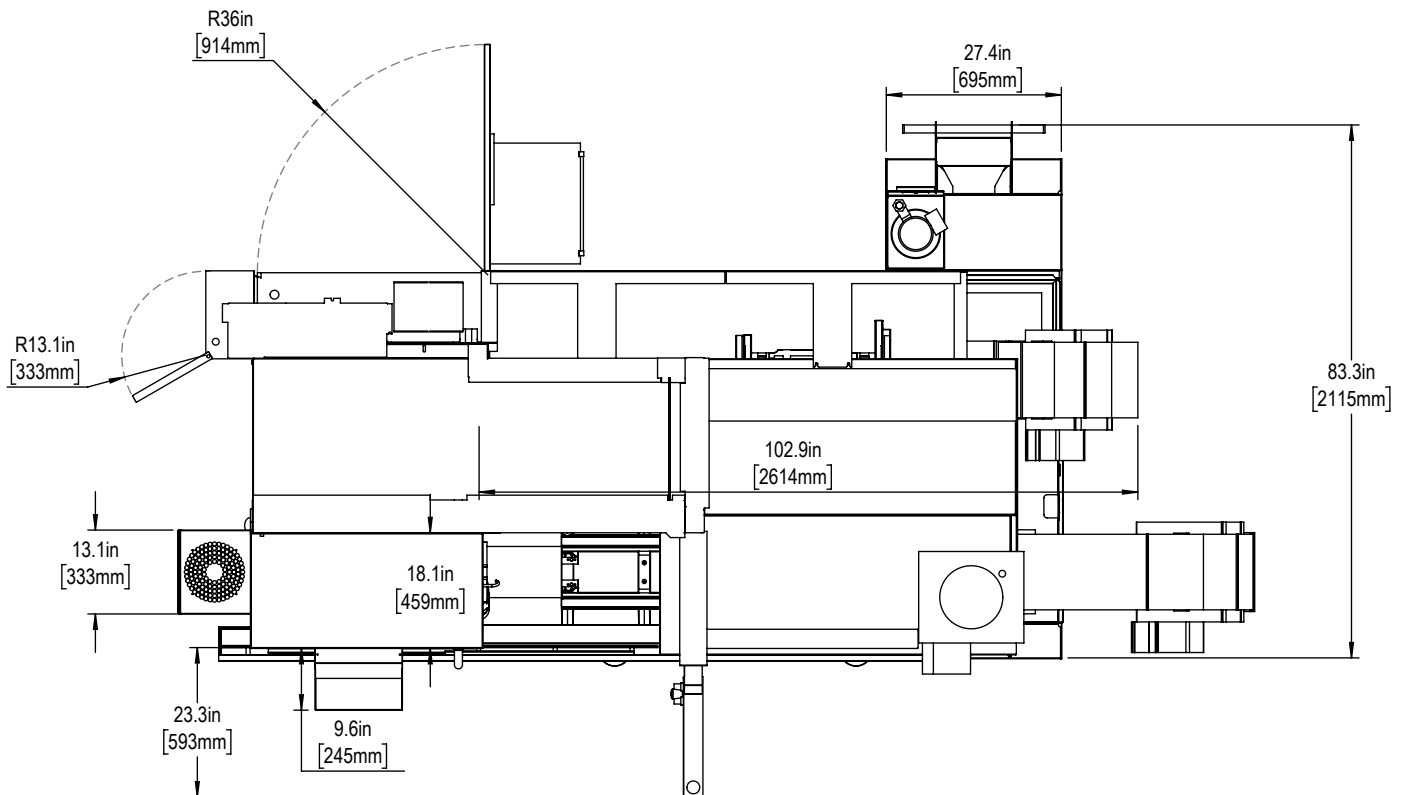

Parallel Plane Envelope Diagrams

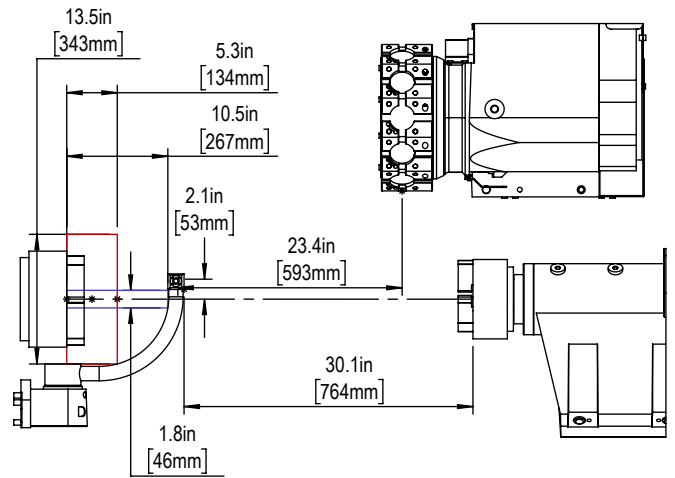
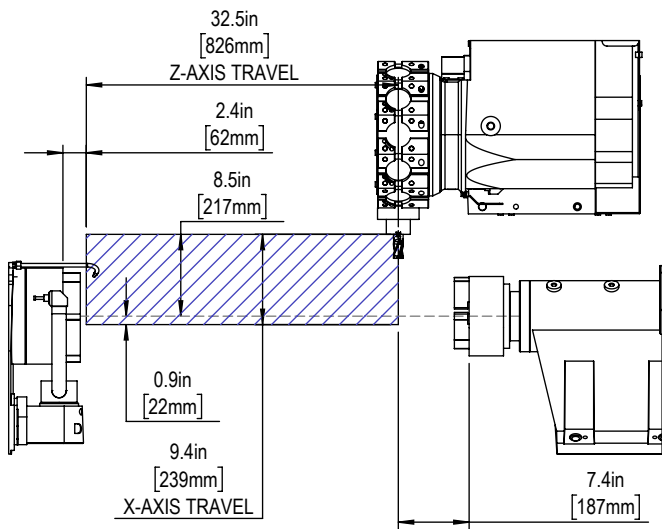
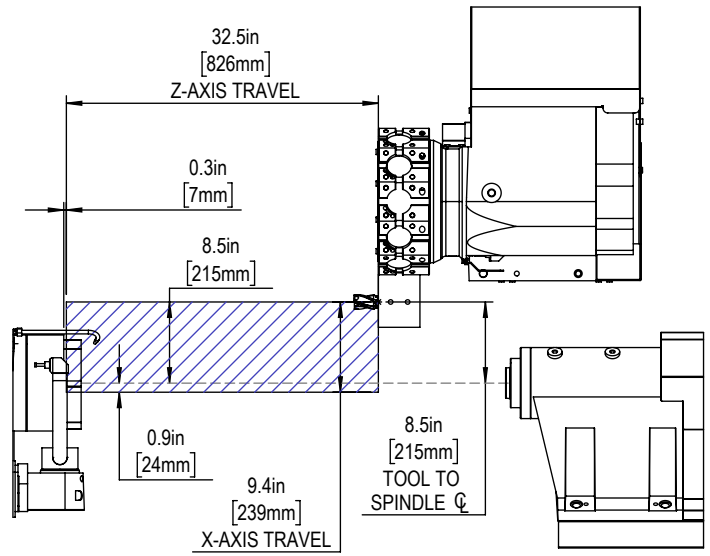
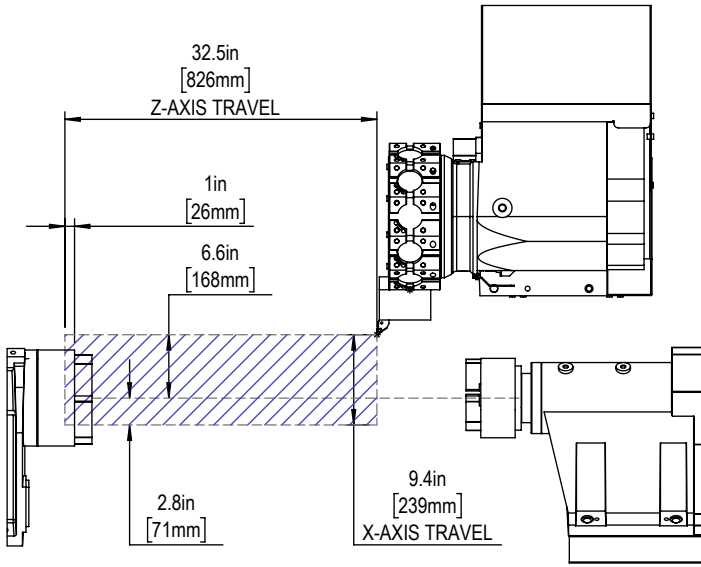

Caution: Avoid coming too close to ATP

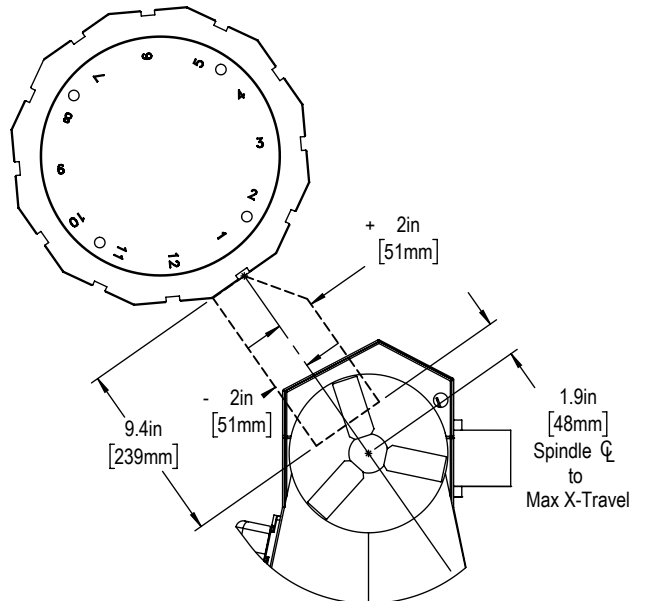
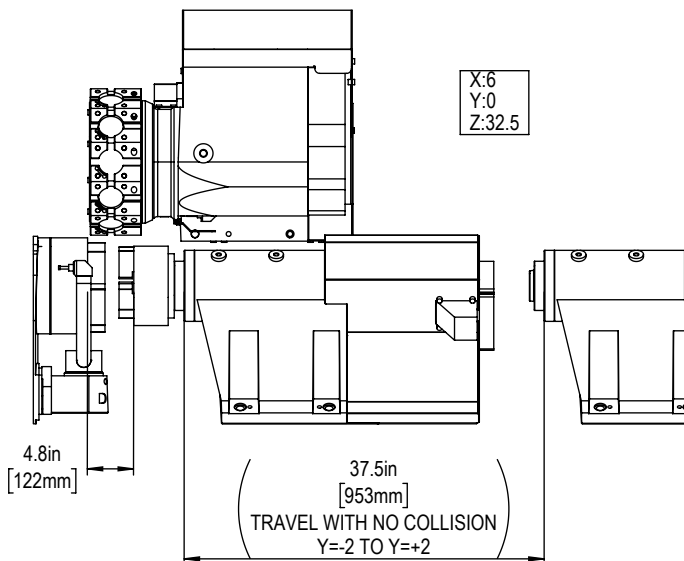

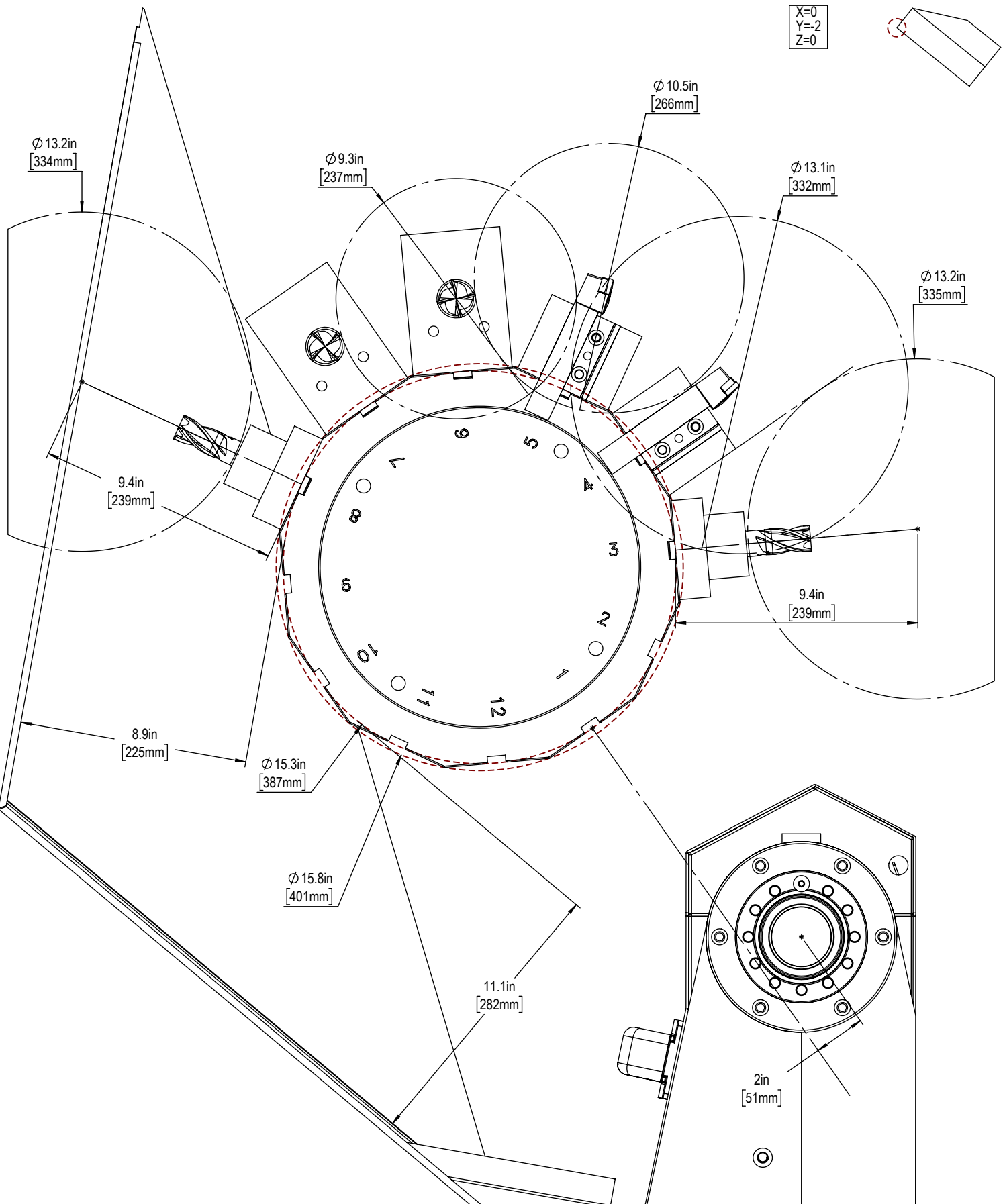

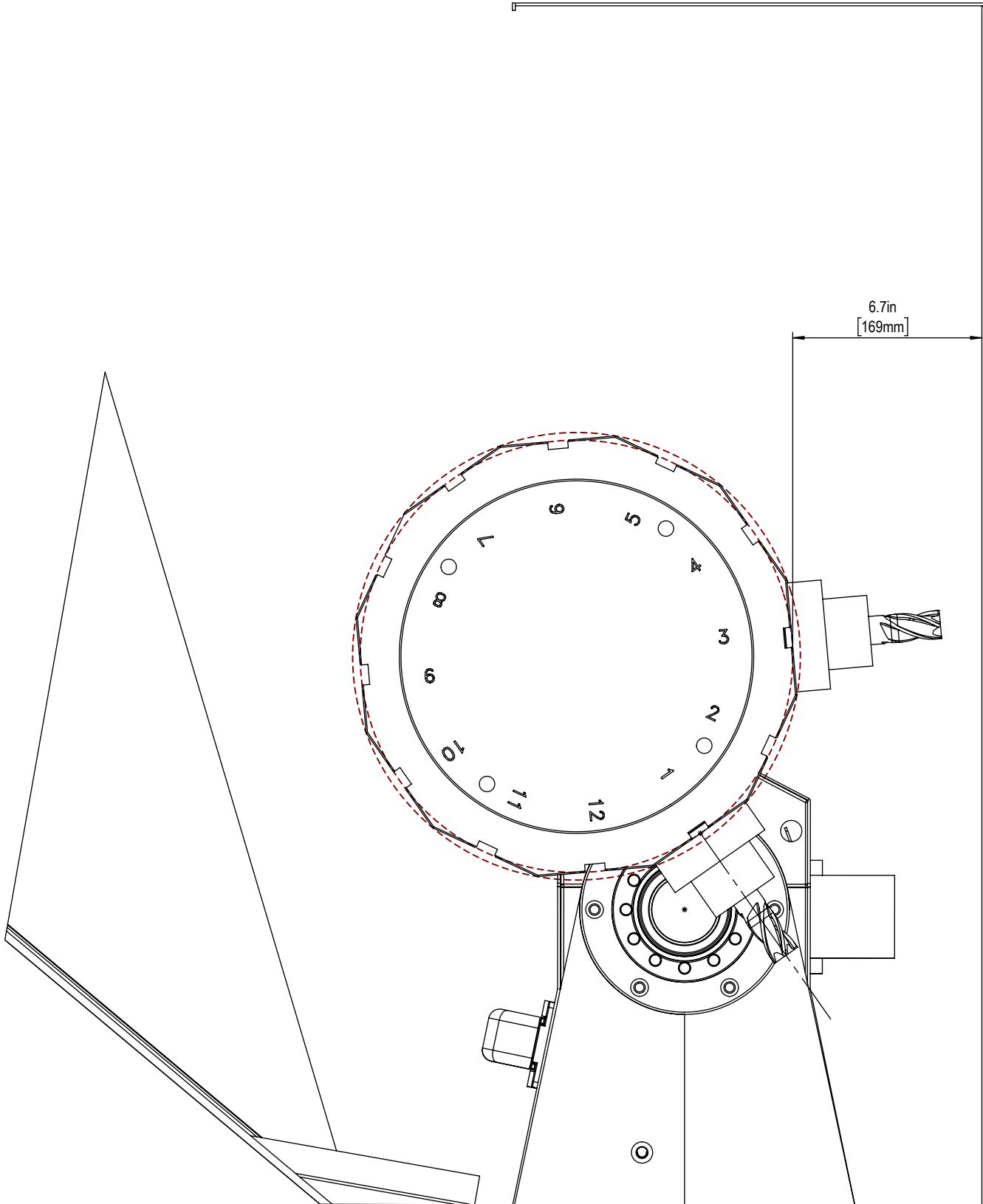
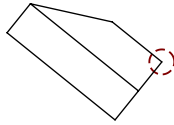

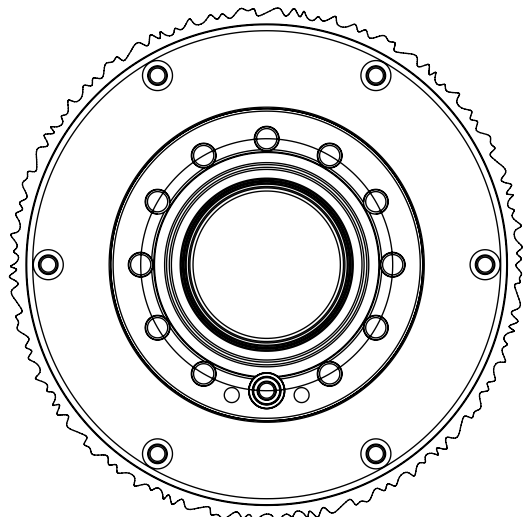
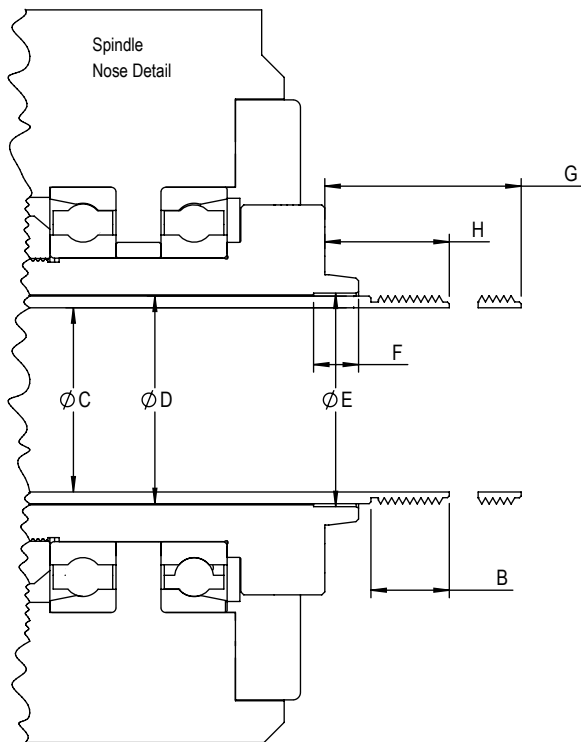
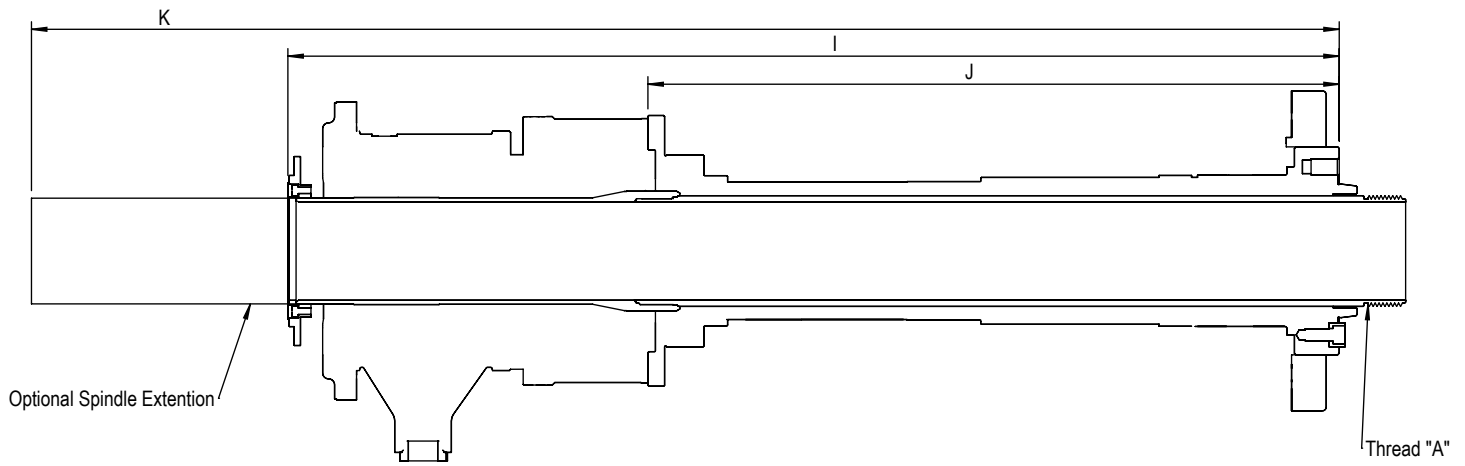

*Due to vendor variations discretion should be taken to verify validity of provided dimensions

Description	DIMENSION PARAMETER	DS-30Y	
		SAE (in)	METRIC (mm)
SPINDLE TYPE		A2-6	
THREAD TYPE	A	M85	
INTERNAL OR EXTERNAL		EXT	
LENGTH OF THREAD	B	1.42	36.1
DRAWTUBE INTERNAL Ø	C	3.03	77
DRAWTUBE EXTERNAL Ø	D	3.42	86.8
COUNTERBORE INTERNAL Ø	E	3.56	90.4
COUNTERBORE DEPTH	F	0.75	19.0
DRAWTUBE EXTENDED	G	2.61	66.3
DRAWTUBE RETRACTED	H	1.47	37.3
SPINDLE FACE TO BACK OF UNION	I	31.10	790
SPINDLE FACE TO UNION ADAPTOR	J	21.61	549
TO BACK OF EXTENSION (OPTION)	K	38.86	987

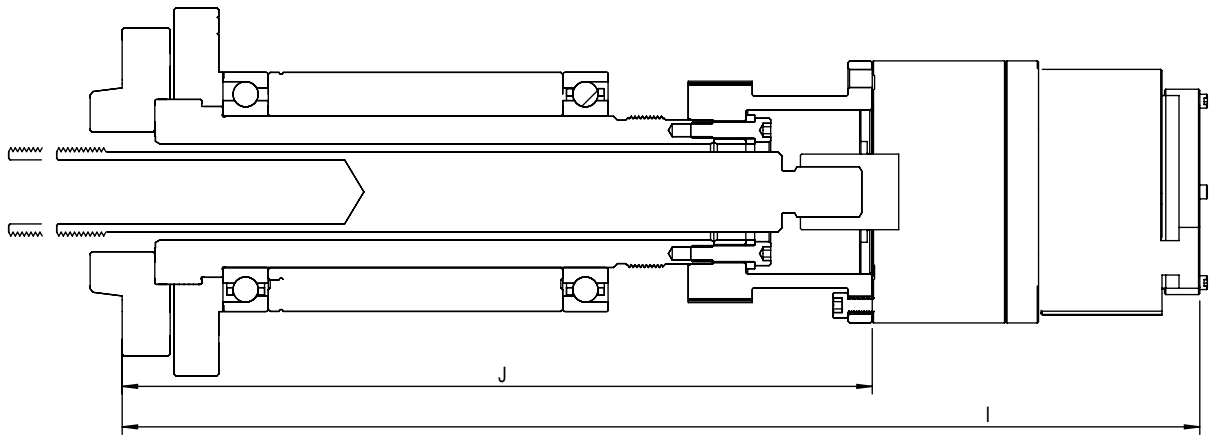

DESCRIPTION	DIMENSION PARAMETER	DS-30Y	
		SAE (in)	METRIC (mm)
SPINDLE TYPE		A2-5	
THREAD TYPE	A	M60	
INTERNAL OR EXTERNAL		EXT	
LENGTH OF THREAD	B	0.95	24.1
DRAWTUBE INTERNAL ϕ	C	-	-
DRAWTUBE EXTERNAL ϕ	D	1.25	31.7
COUNTERBORE INTERNAL ϕ	E	2.50	63.5
COUNTERBORE DEPTH	F	0.62	15.7
DRAWTUBE EXTENDED	G	2.25	57.1
DRAWTUBE RETRACTED	H	1.26	32.1
SPINDLE FACE TO BACK OF UNION	I	30.71	780
SPINDLE FACE TO UNION ADAPTOR	J	22.56	573
EJECTOR POCKET DEPTH	K	1.75	44.5
EJECTOR POCKET DIAMETER	L	0.81	20.6

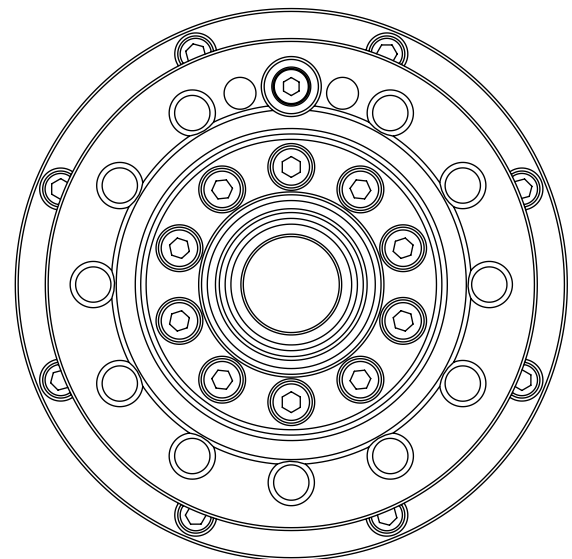
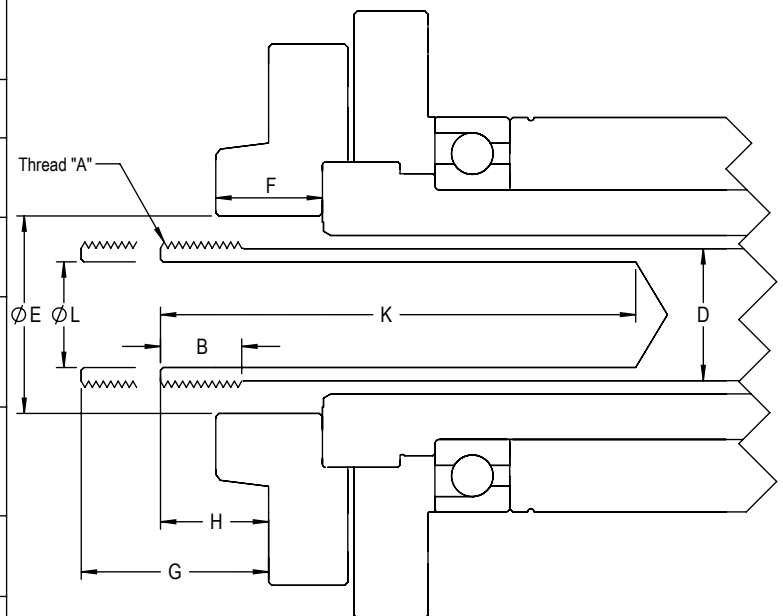

*Due to vendor variations discretion should be taken to verify validity of provided dimensions