

TOP VIEW - OPERATIONAL LENGTH AND WIDTH

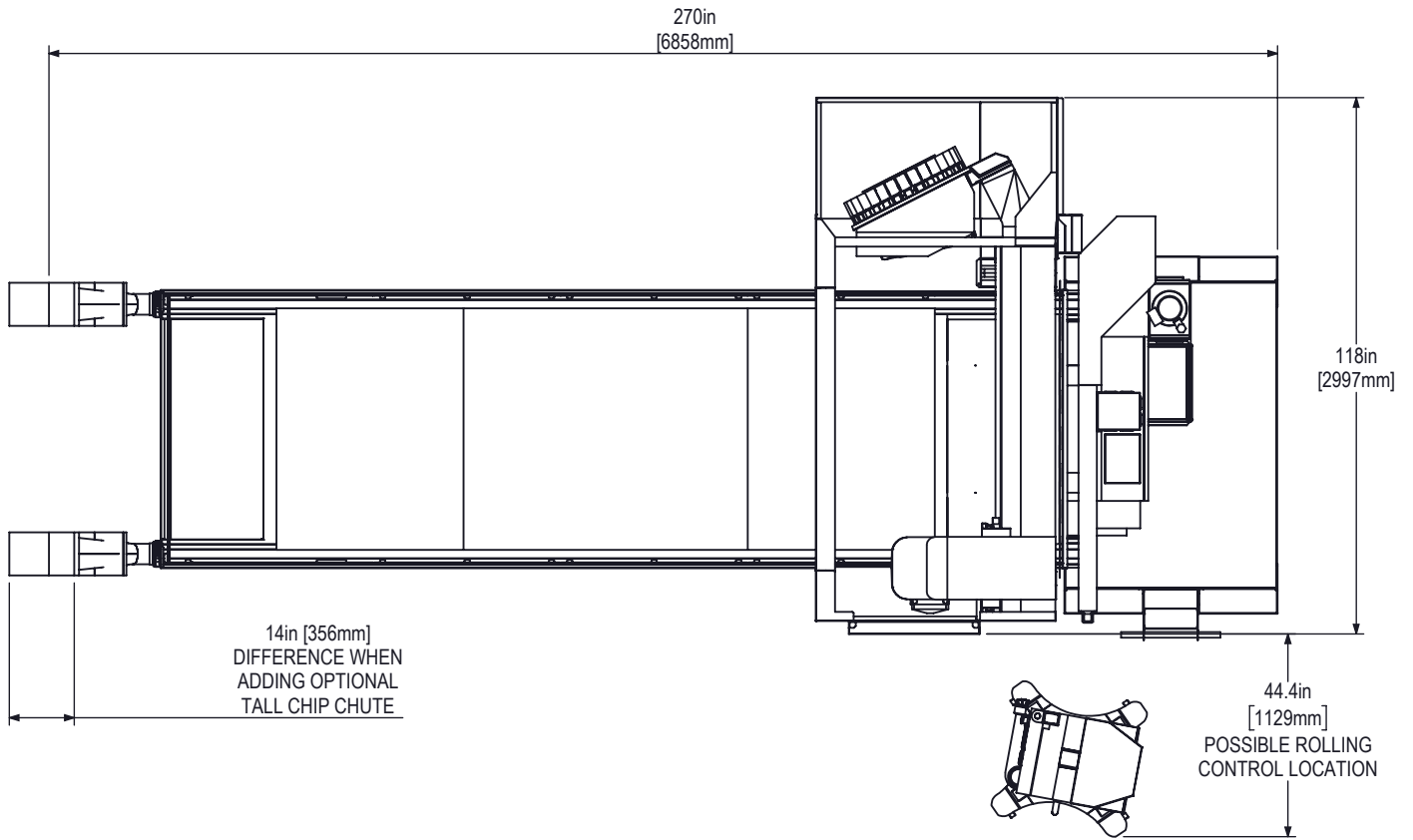

RIGHT VIEW - OPERATIONAL HEIGHT

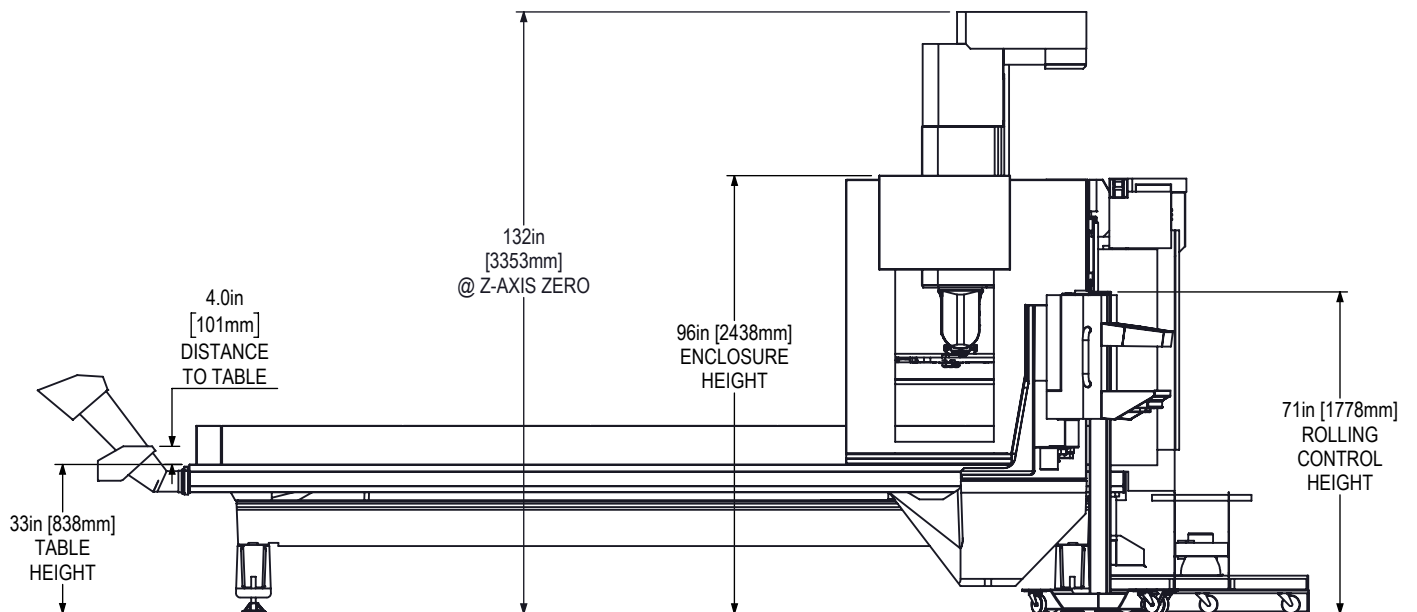

TOP VIEW

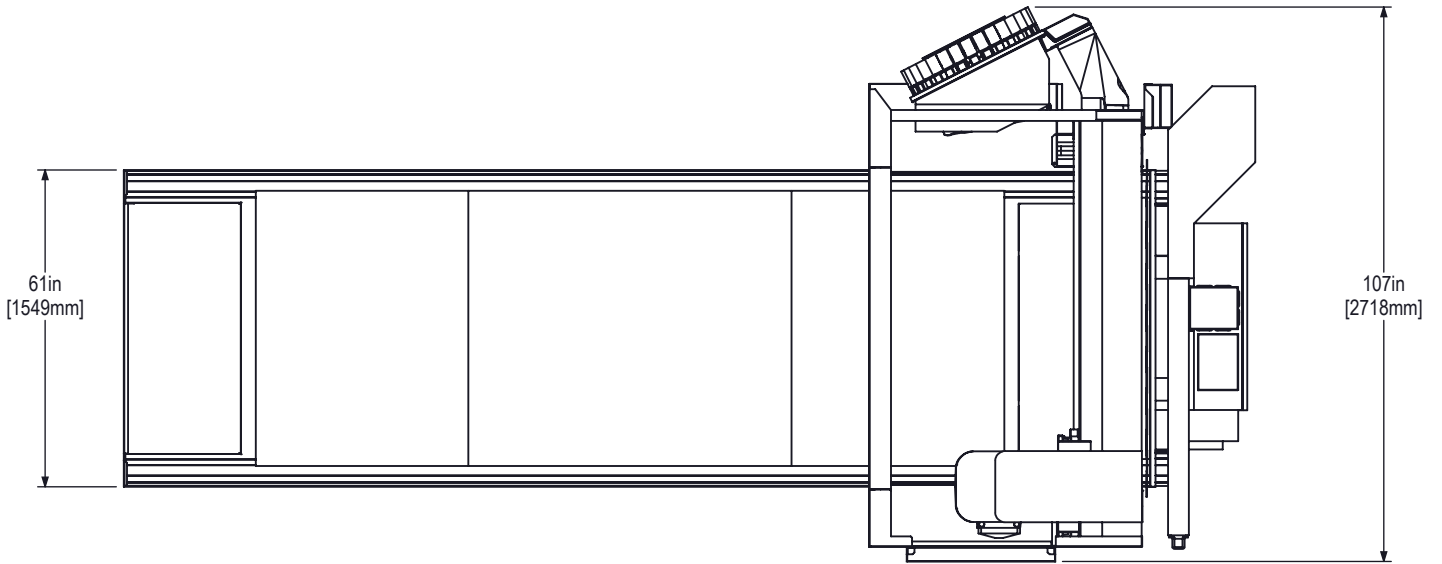

DIMENSIONS GIVEN ARE AS MACHINE SHIPS - SOME SHEETMETAL REMOVED
PALLET AND SHIPPING MATERIALS REMOVED

SIDE VIEW

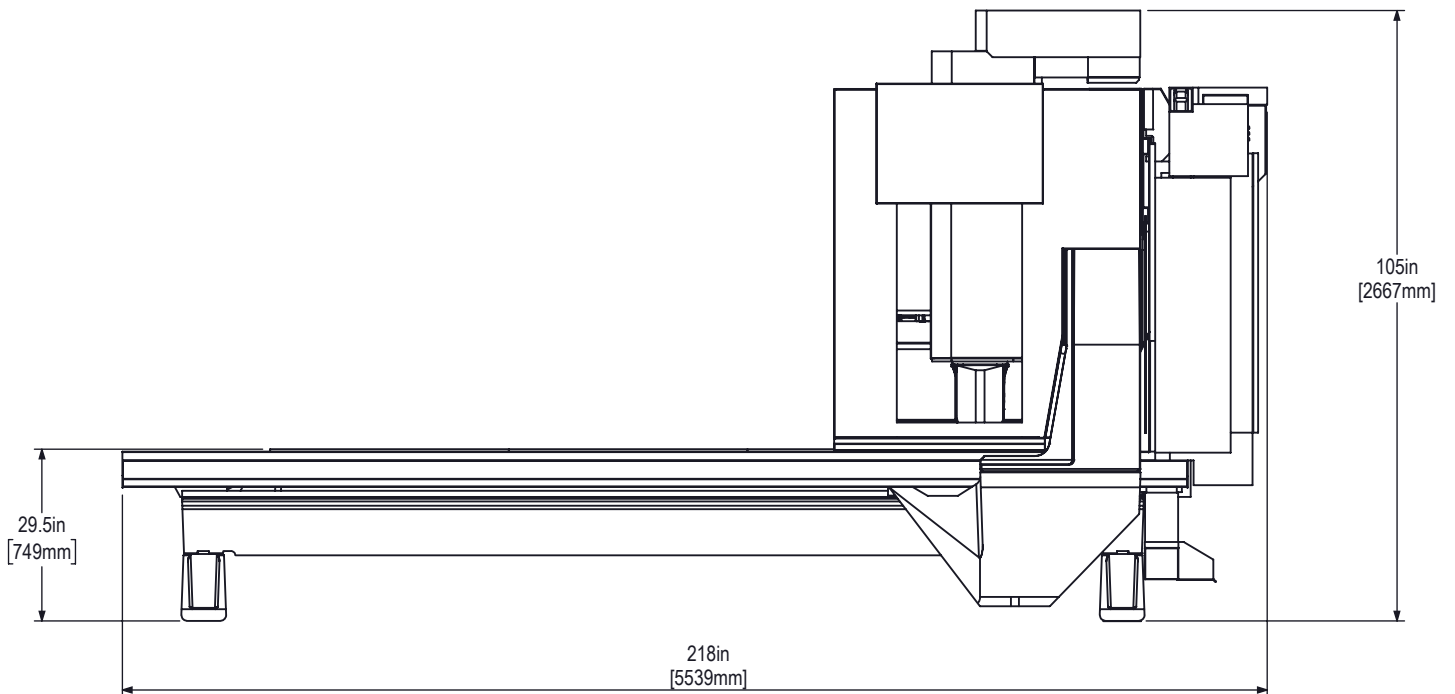

SIDE VIEW

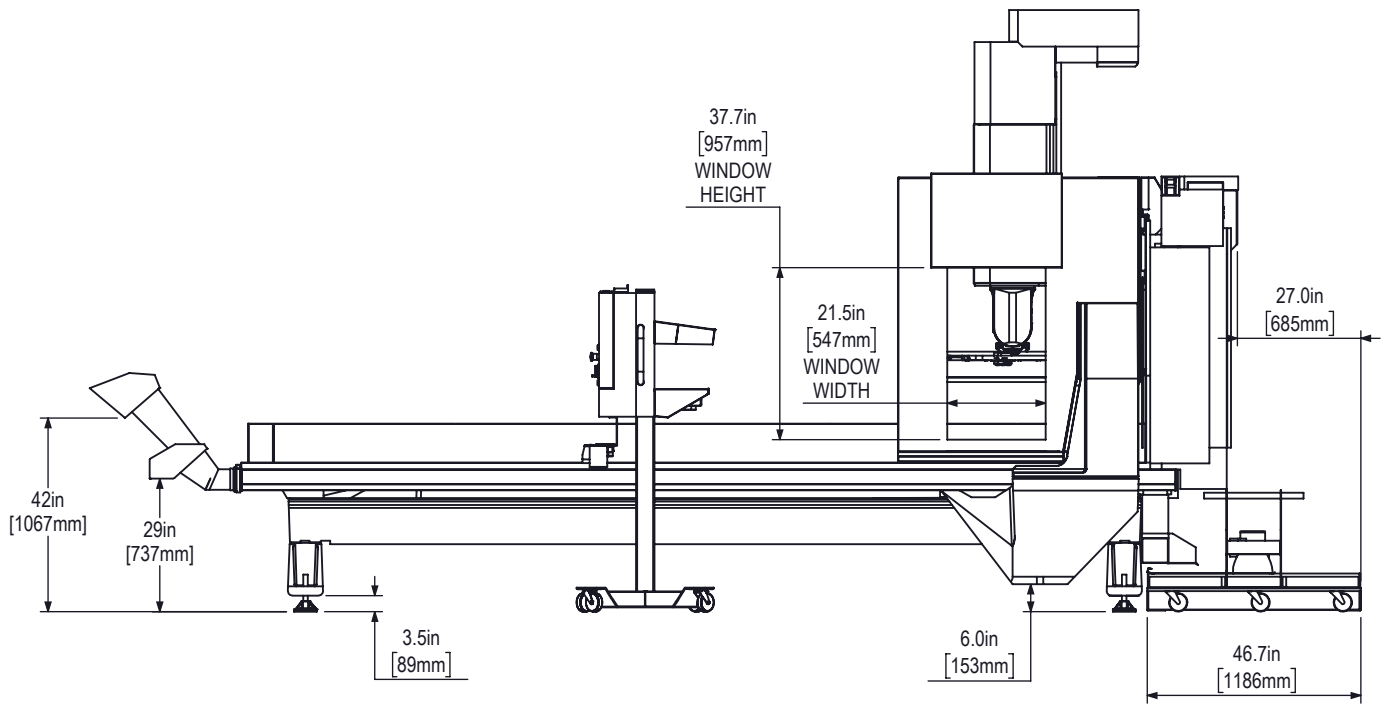

TOP VIEW

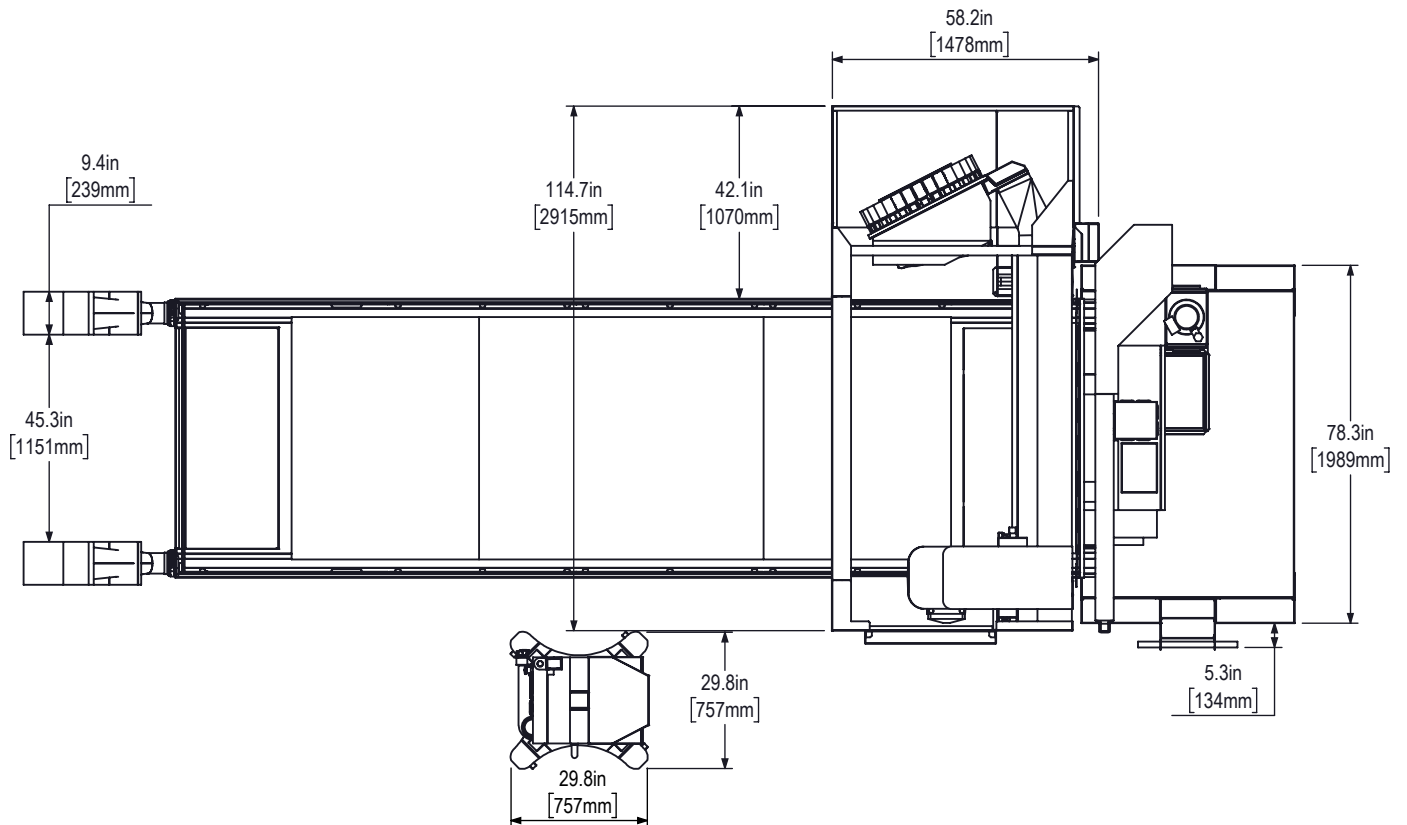



WORK AREA CLEARANCE DETAILS
58in {1473} WITH SPLASH GUARDS INSTALLED
60in [1524mm] WITHOUT SPLASH GUARDS
62in [1575mm] WHEN PART IS 2in {51mm} ABOVE TABLE HEIGHT

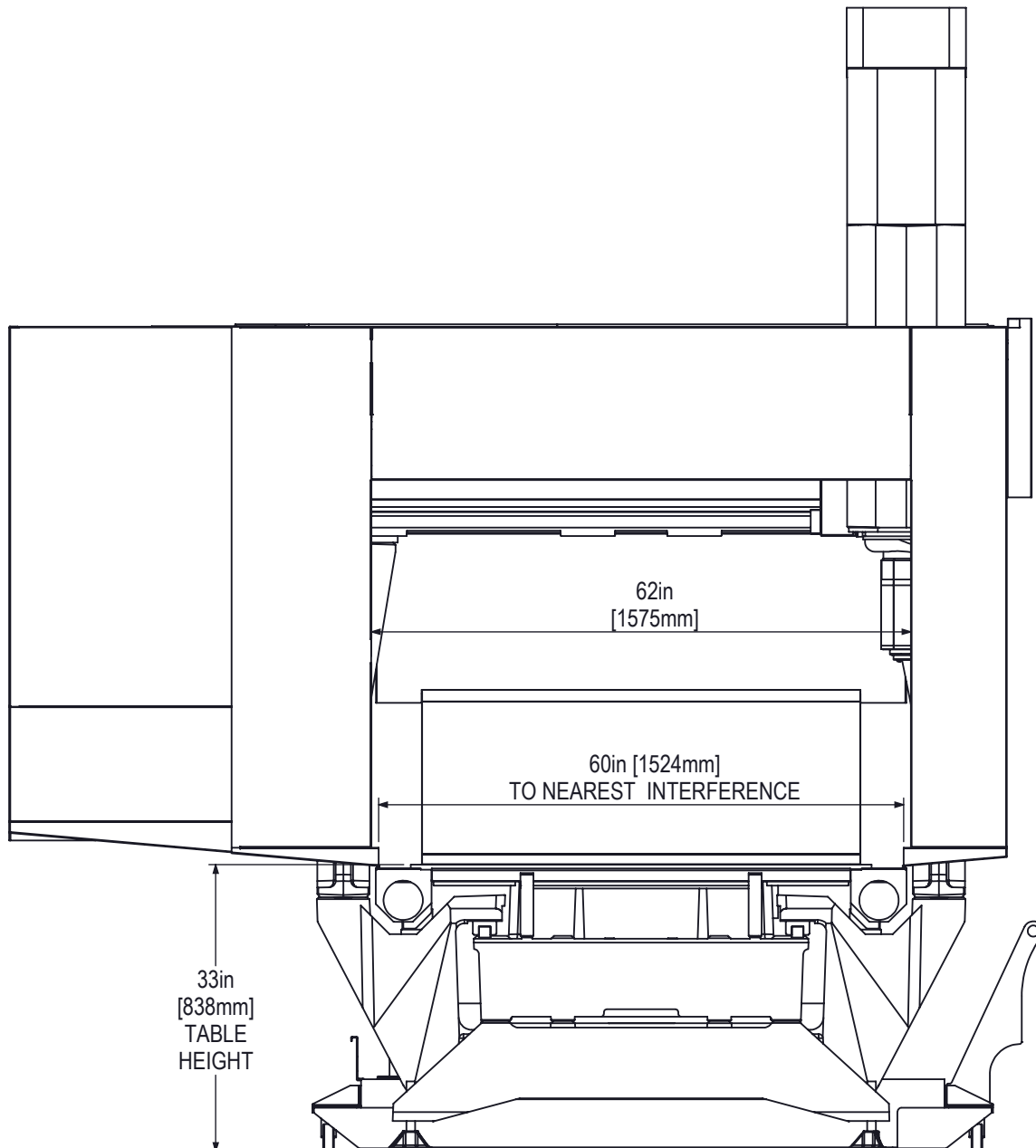

RIGHT SIDE VIEW
ELECTRICAL CABINET SIDE

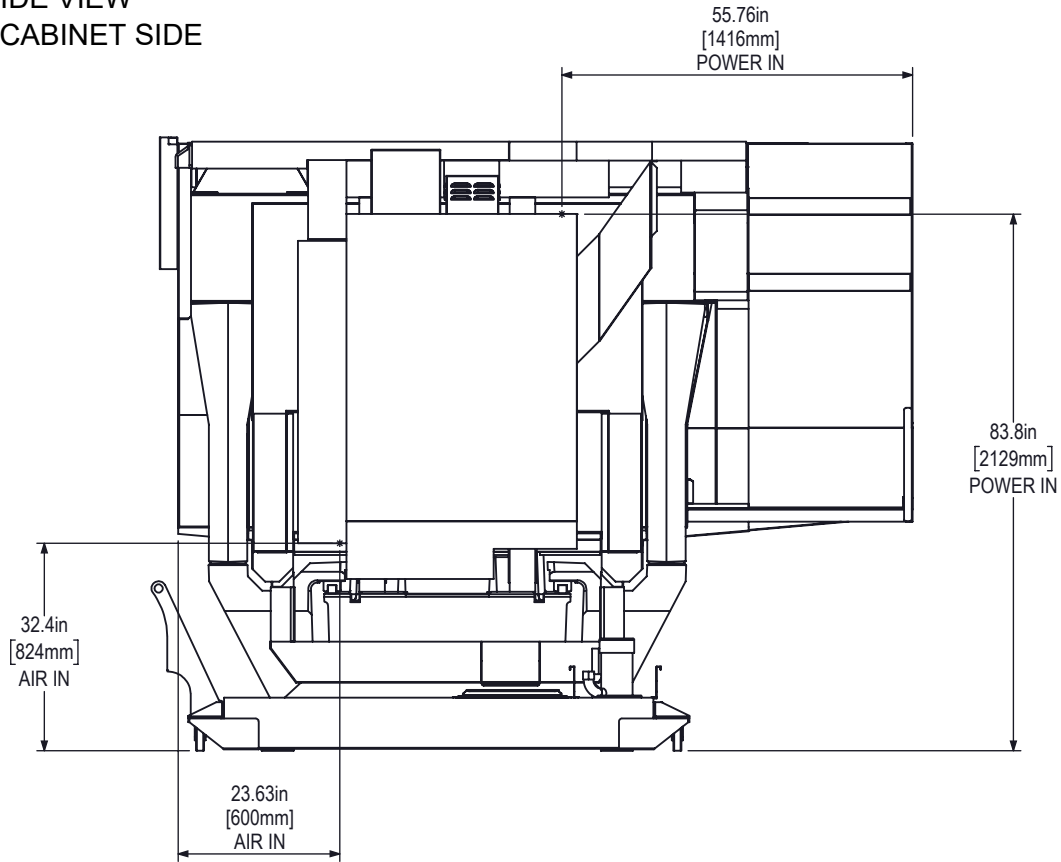

MACHINE MUST BE PLACED ON A SINGLE CONTINUOUS CONCRETE SLAB. SLAB MUST EXTEND 12in [305mm] BEYOND LEVELING PAD LOCATIONS IN ALL DIRECTIONS

BOTTOM VIEW

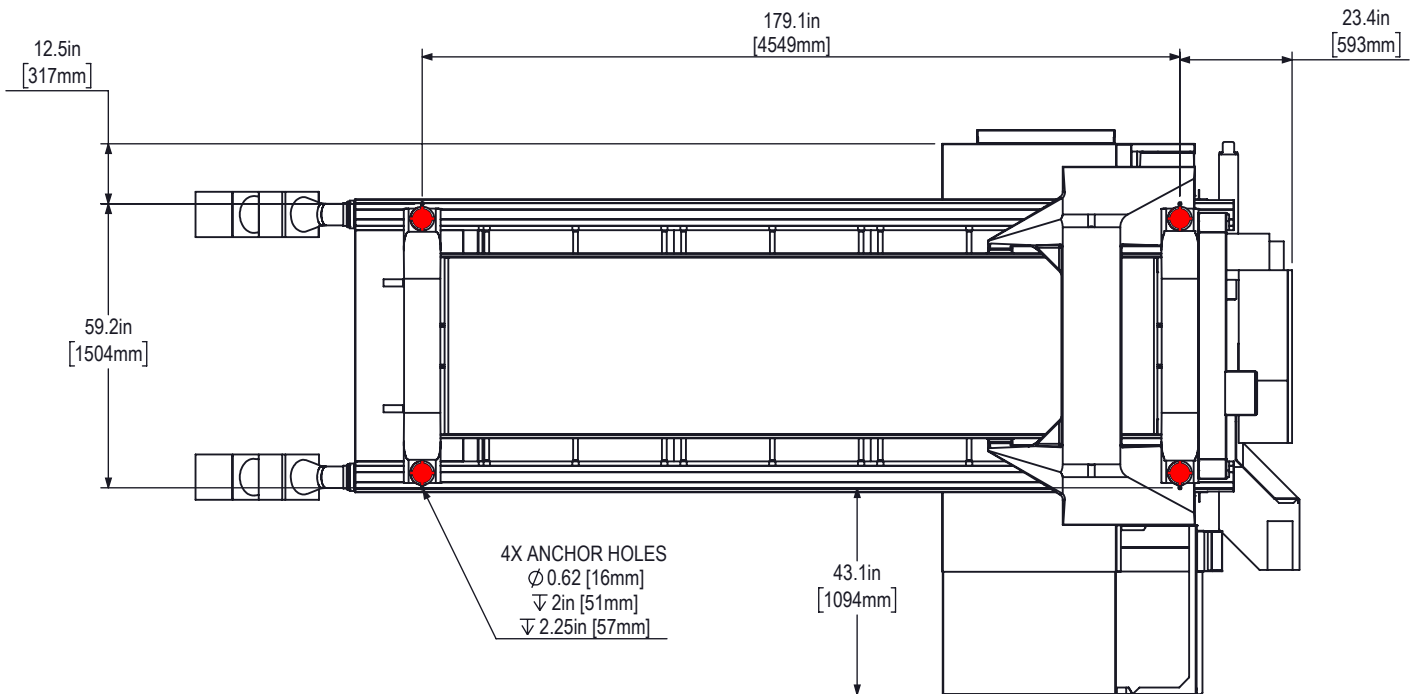

DRAWING NOT TO SCALE

X & Y Axis Clearance

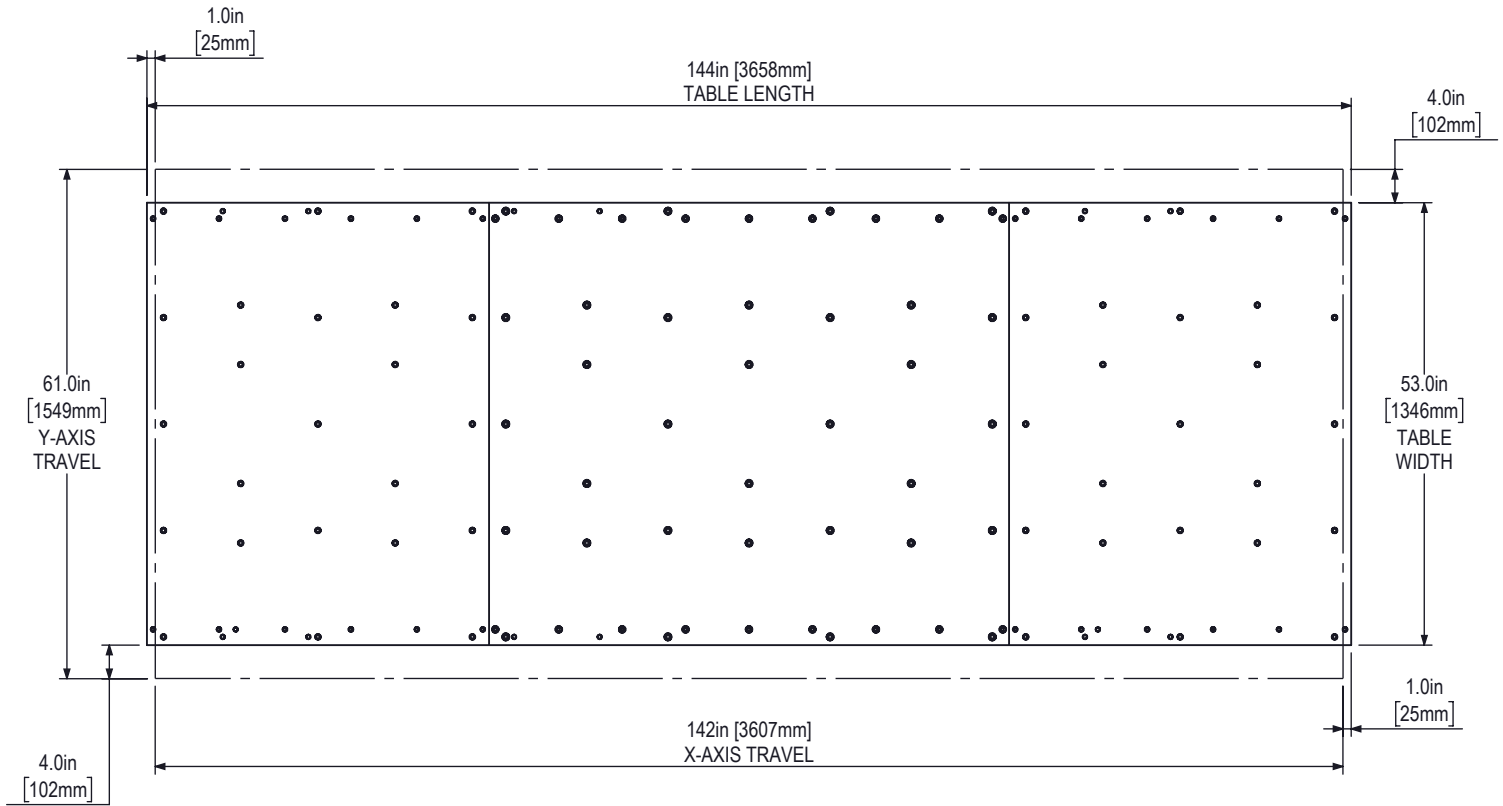

X AND Y HOME ZERO IS BOTTOM RIGHT CORNER OF TRAVEL BOX

Z-AXIS TRAVELS AND CLEARANCES

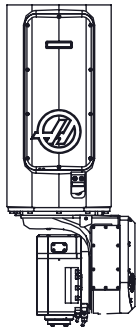

NOTE: POSSIBLE COLLISION
Z-AXIS TRAVEL WILL ALLOW SPINDLE
TO GO PAST THE TABLE WHEN
THE B-AXIS IS AT ZERO DEGREES

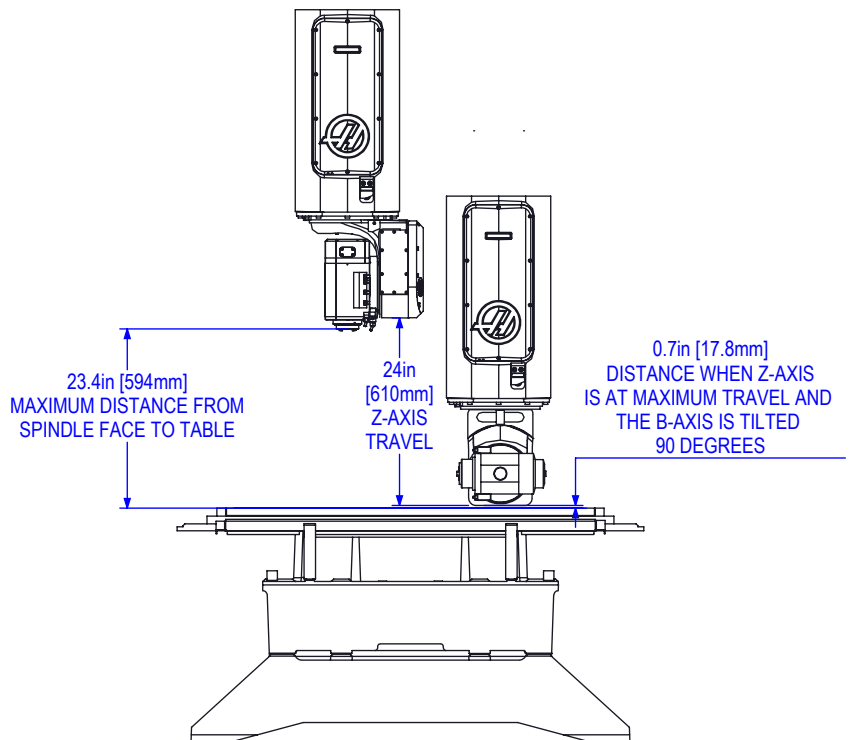

90-DEGREE TILT

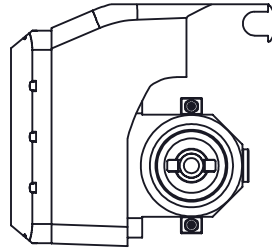
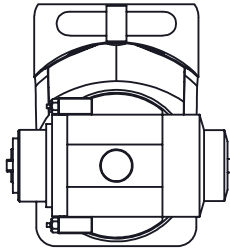

ISO VIEW

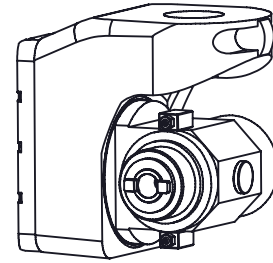

NOTES:

- 1) THE SKETCH BELOW SHOWS THE SPINDLE AT 90-DEGREES WITH NO TOOL IN THE SPINDLE
- 2) THE WORK ENVELOPE IS REDUCED WHEN THE SPINDLE IS TILTED AT 90-DEGREES TOWARDS THE CENTER OF TRAVEL IN THE X-AXIS OR Y-AXIS DIRECTION AS SHOWN
- 3) THE WORK ENVELOPE WILL BE REDUCED BY THE LENGTH OF THE TOOL WHEN MACHINING FEATURES ON BOTH SIDES OF THE PART
- 4) 142in [3607mm] X 50in [1270mm] POSSIBLE WORK ENVELOPE AS SHOWN BELOW WHEN HEAD IS TILTED 90 DEGREES

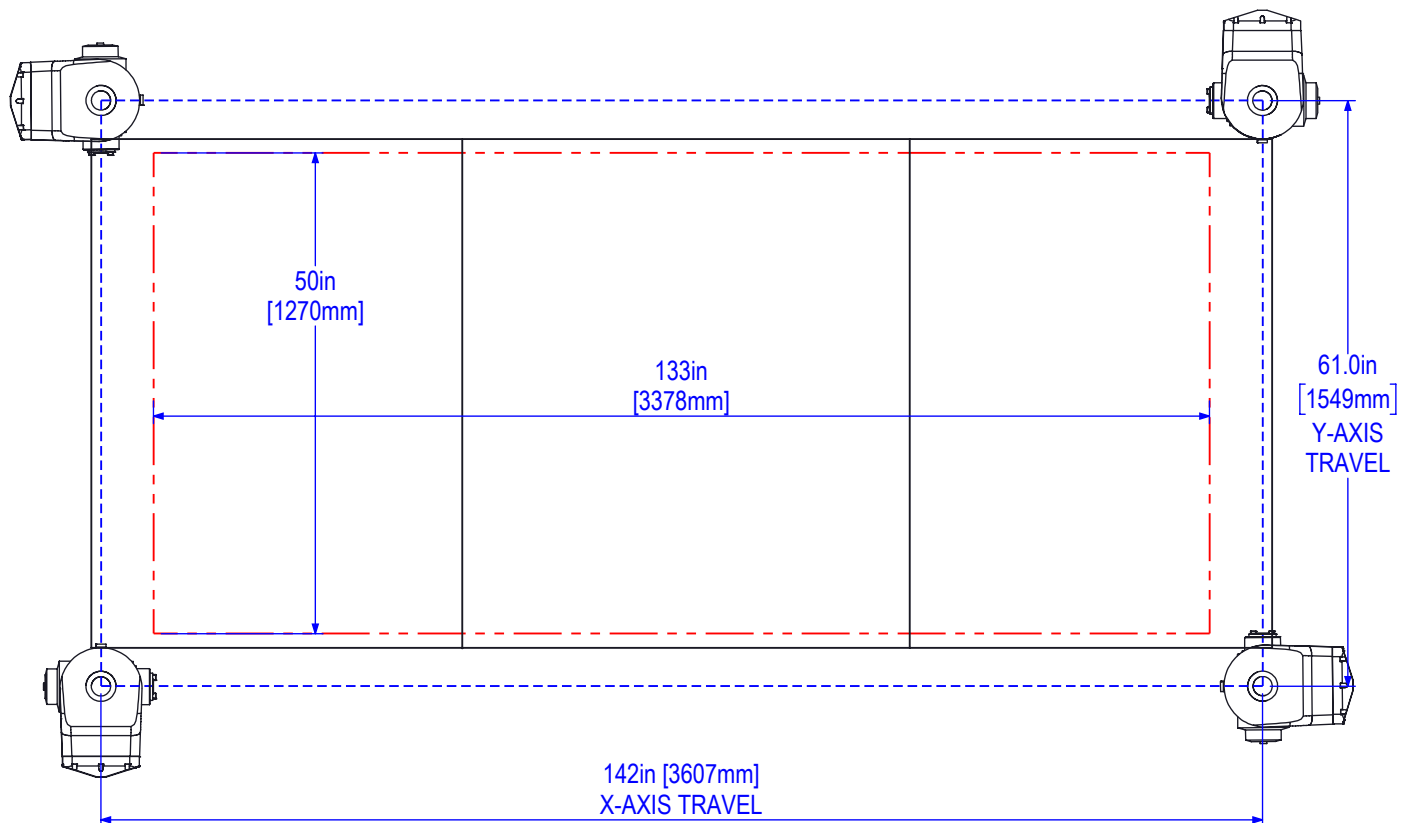

DRAWING NOT TO SCALE



FRONT VIEW

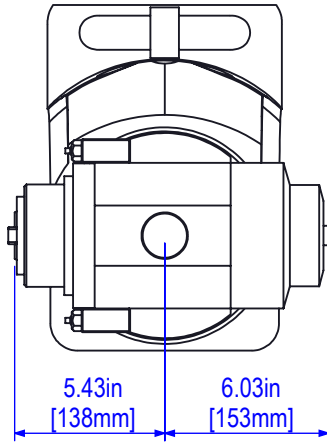

ISO VIEW

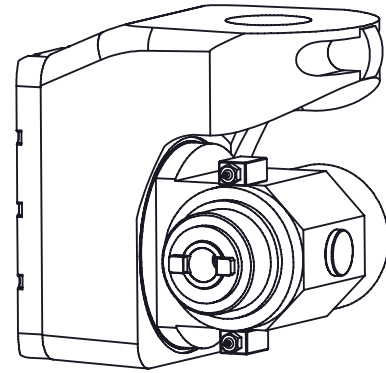

APPROXIMATE CENTER OF ROTATION
5.425in [138mm]

SIDE VIEW

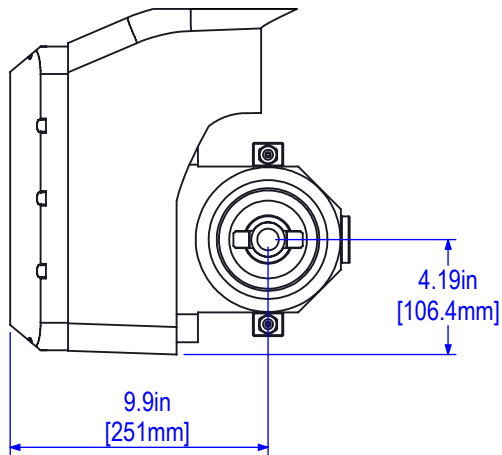

REAR VIEW

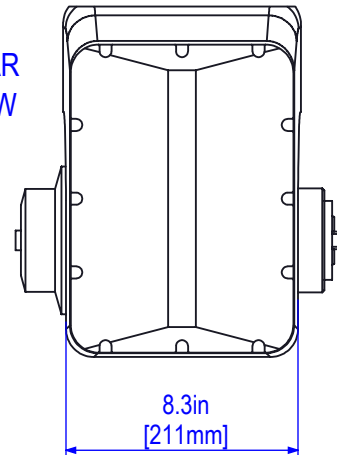

TOP VIEW

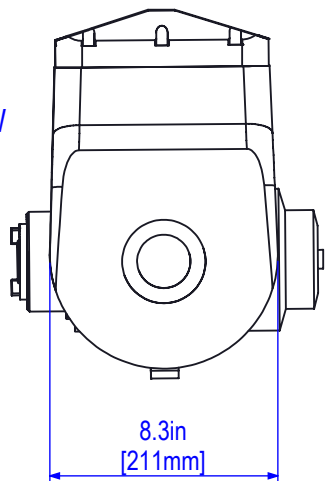

FRONT VIEW

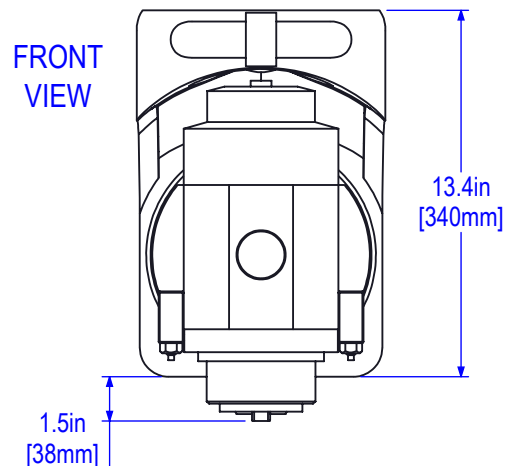

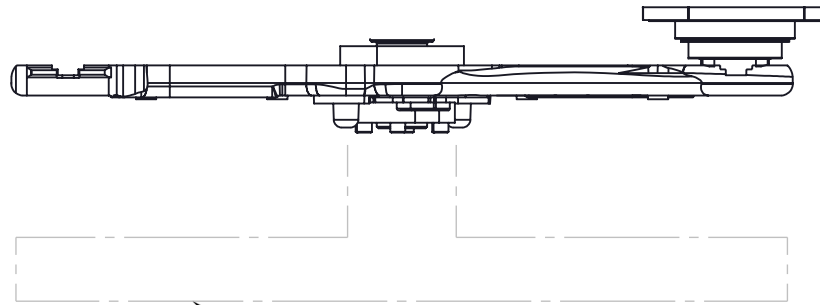

4.5in
[114mm]
DROP DISTANCE
DURING TOOL CHANGE

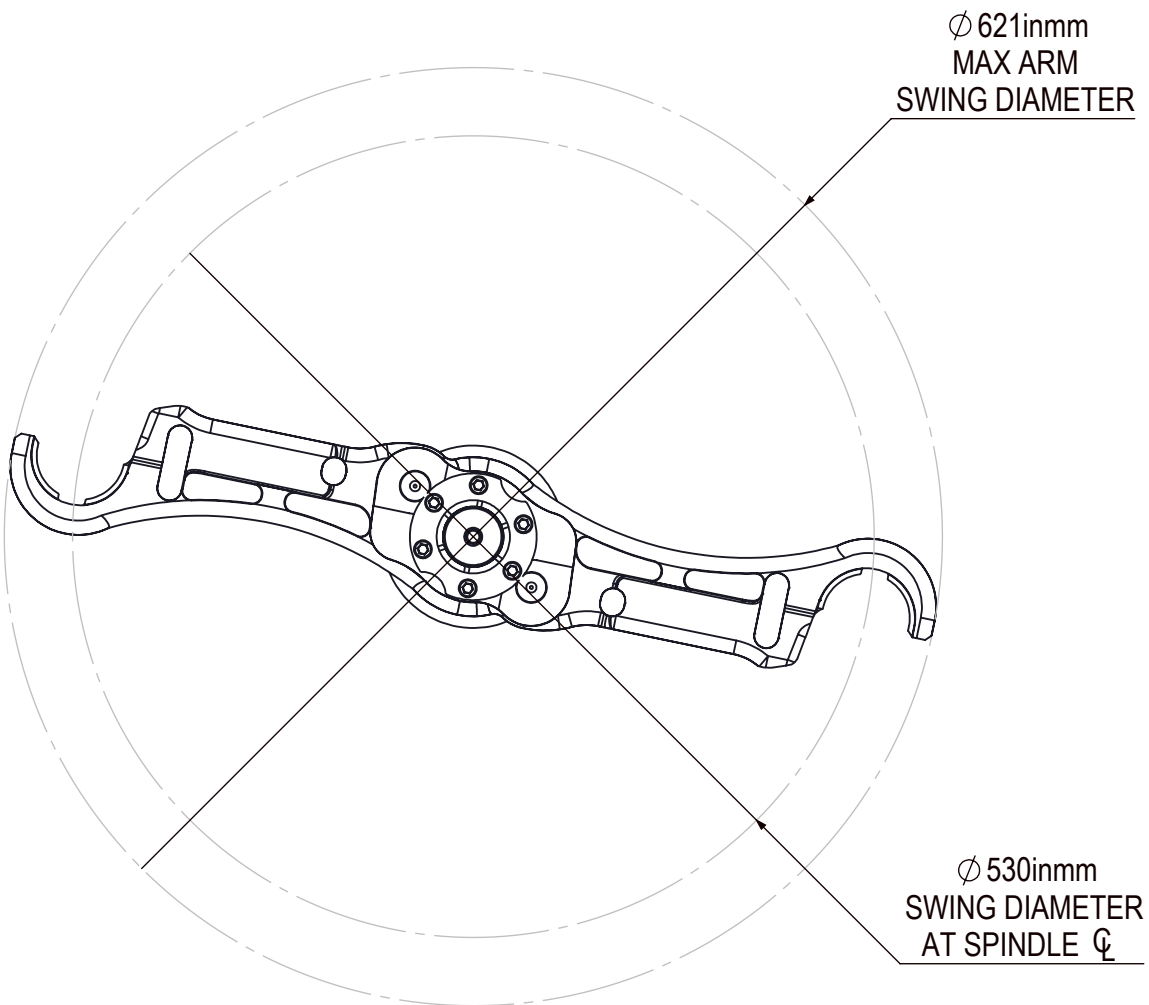



53.0in
[1346mm]
TABLE WIDTH

TABLE HAS 3
SECTIONS TOTAL

TABLE THICKNESS
1in [25.4mm]

DRILL AND TAP
AS NEEDED FOR
CUSTOM
WORKHOLDING

144in
[3658mm]
TABLE
LENGTH

62in
[1575mm]

**DO NOT
DRILL THRU**

THERE ARE NO
HOLE LOCATION
DRILLING
LIMITATIONS

2X 41in
[1042mm]

EXISTING HOLES
ARE NOT AVAILABLE
FOR WORKHOLDING

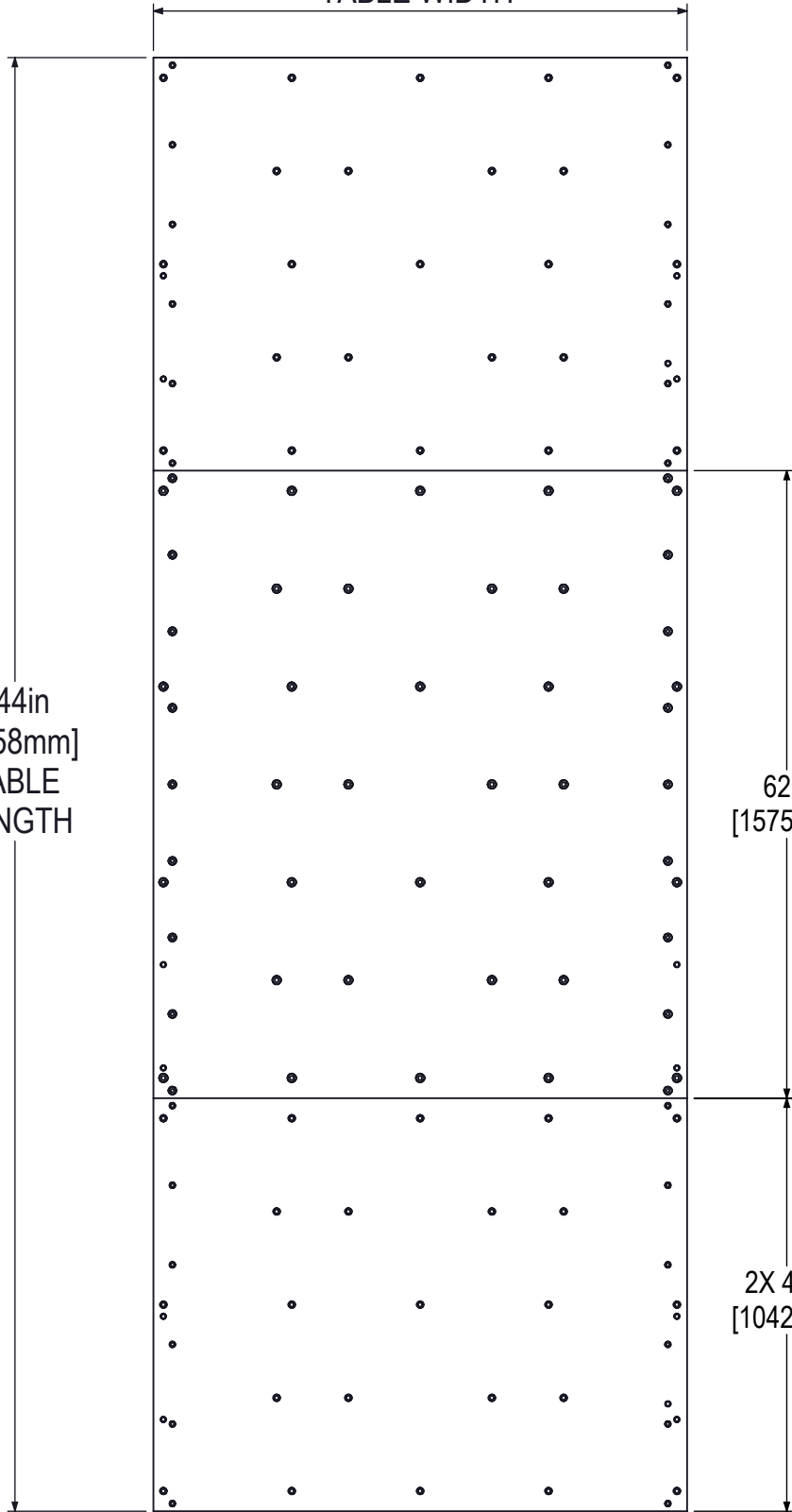



TABLE THICKNESS
1in [25.4mm]

ALL THREADED HOLES
ARE 1/2-13 UNC - 2B
▽ 0.7in [17.78mm]

128 THREADED
HOLES PER
END PLATES

193 THREADED
HOLES PER
MIDDLE PLATE

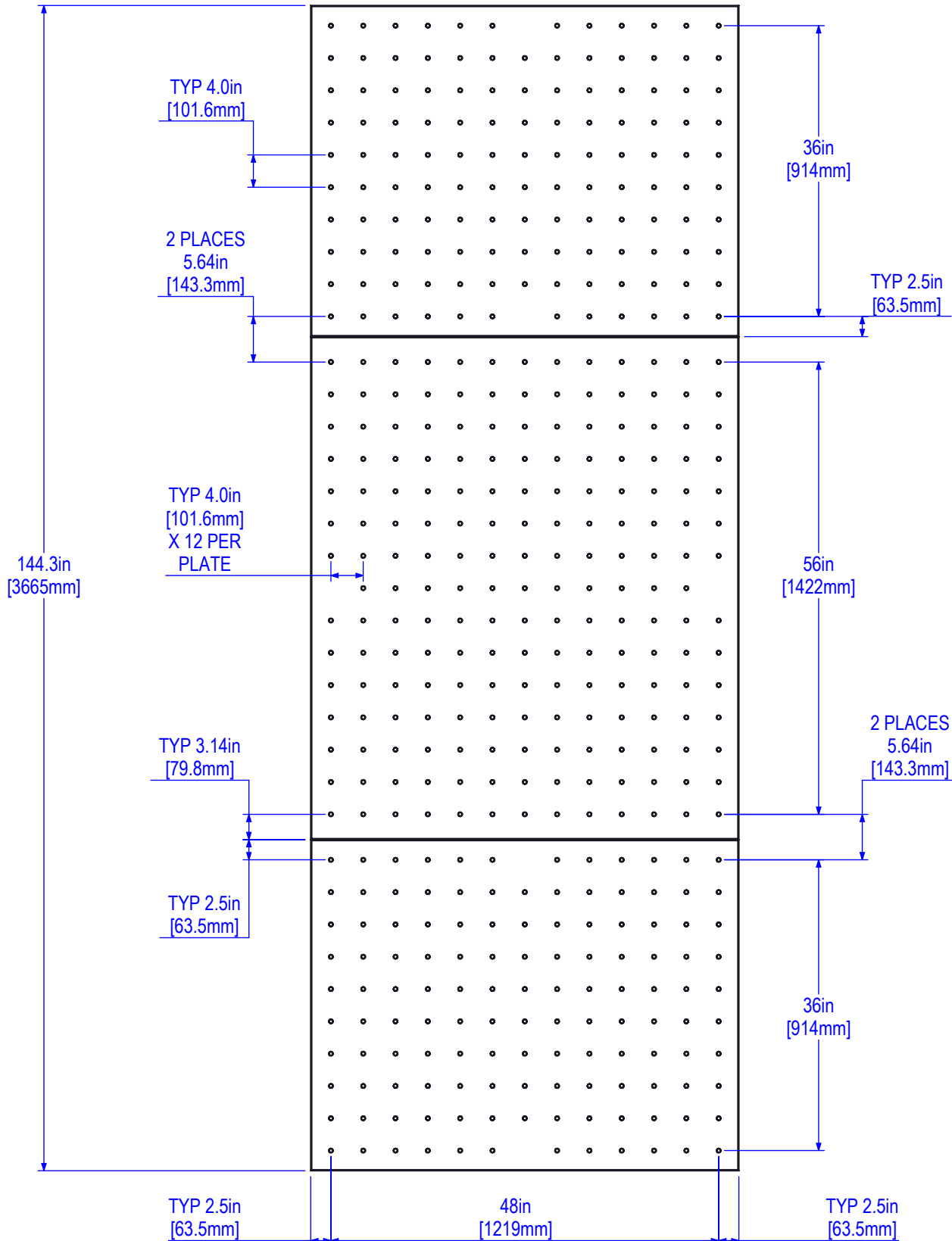

TABLE THICKNESS
1in [25.4mm]

ALL THREADED HOLES
ARE M12 X 1.75 - 6H
▽ 17.8mm [0.7in]

128 THREADED
HOLES PER
END PLATES

195 THREADED
HOLES PER
MIDDLE PLATE

