

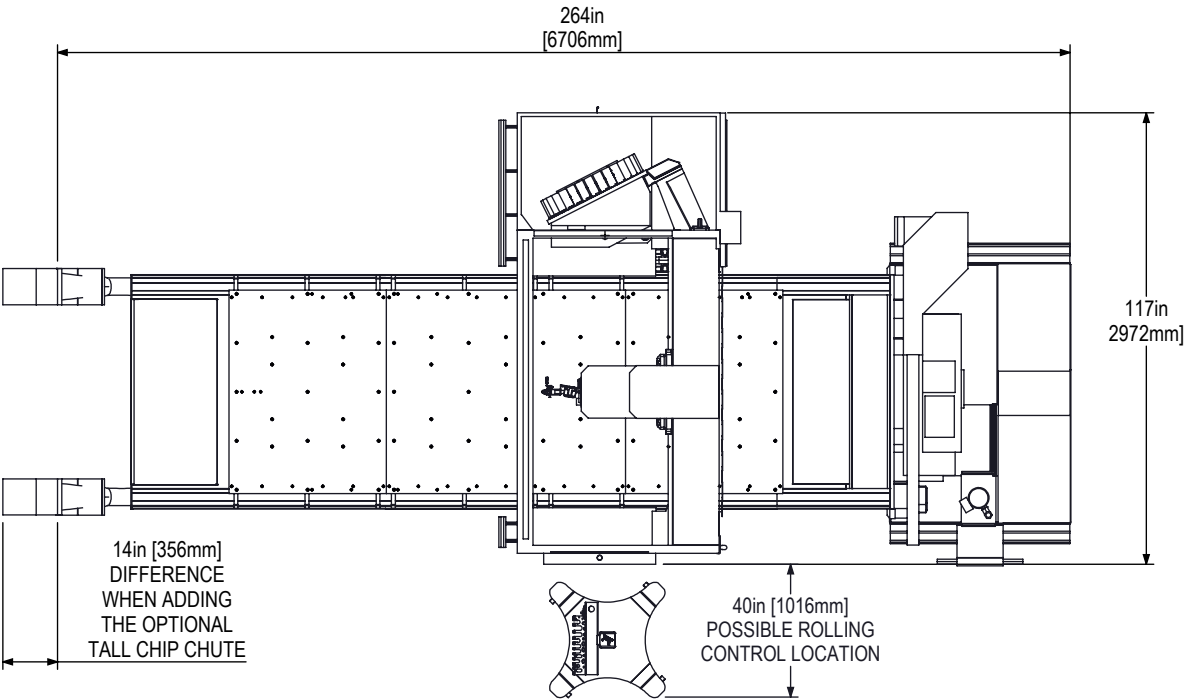

TOP VIEW - OPERATIONAL LENGTH AND WIDTH

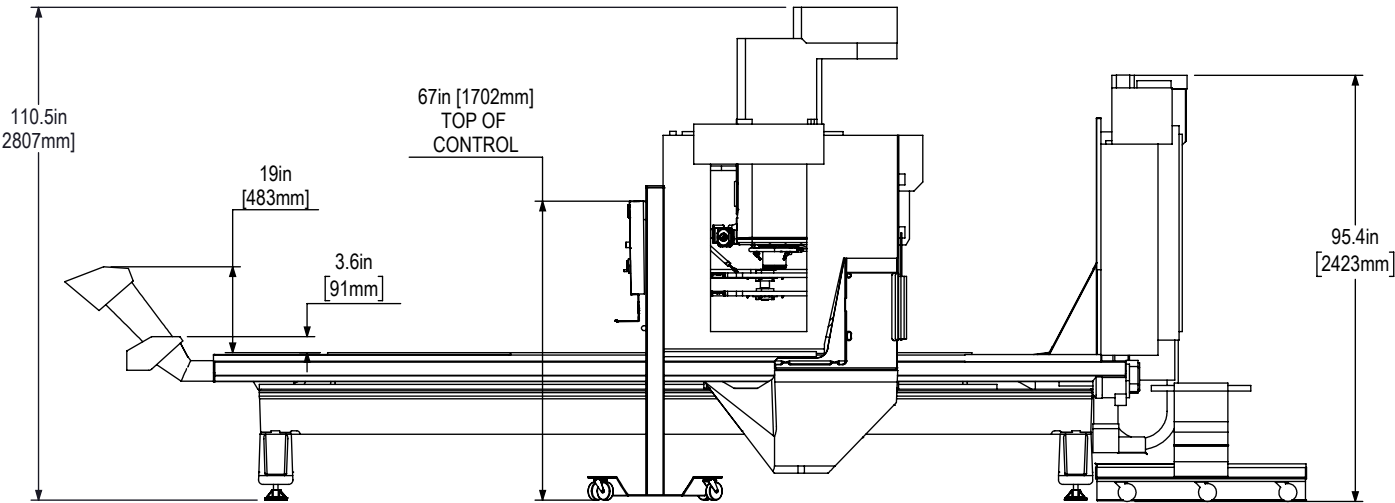

RIGHT VIEW - OPERATIONAL HEIGHT





TOP VIEW

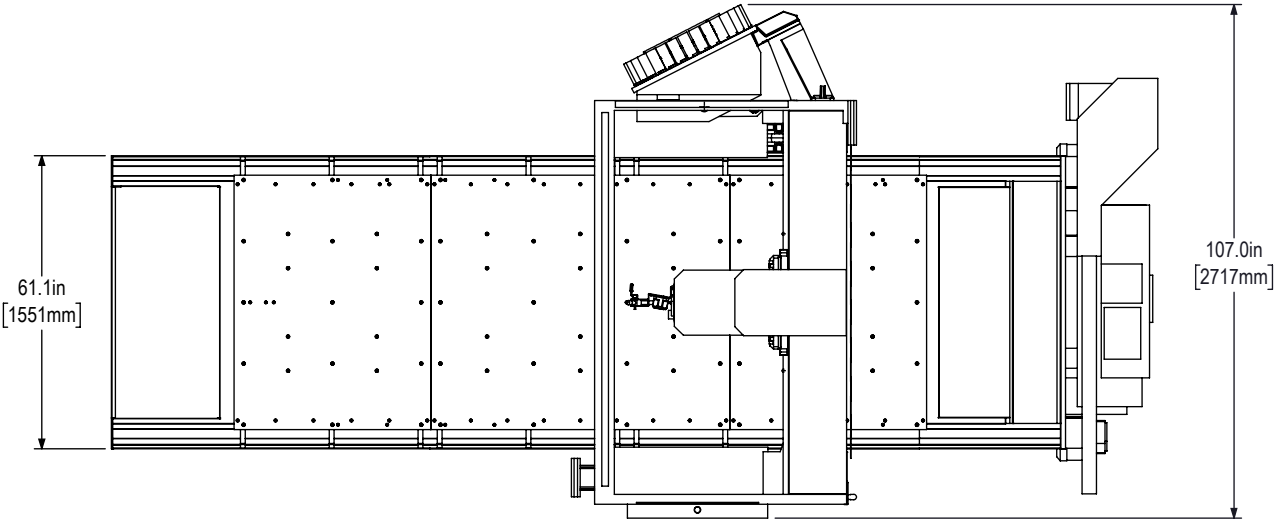

DIMENSIONS GIVEN ARE AS MACHINE SHIPS - SOME SHEETMETAL REMOVED

SIDE VIEW

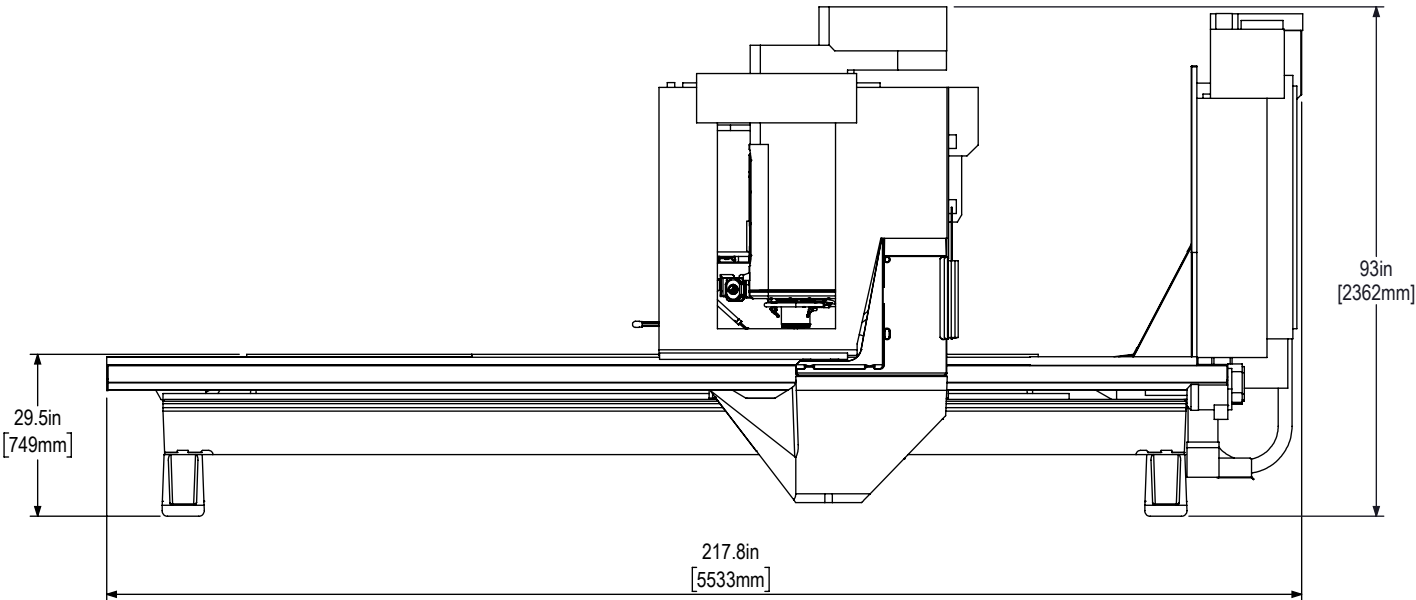

DIMENSIONS GIVEN ARE OFF OF THE PALLET AND WITHOUT LEVELING FEET



OPERATOR VIEW

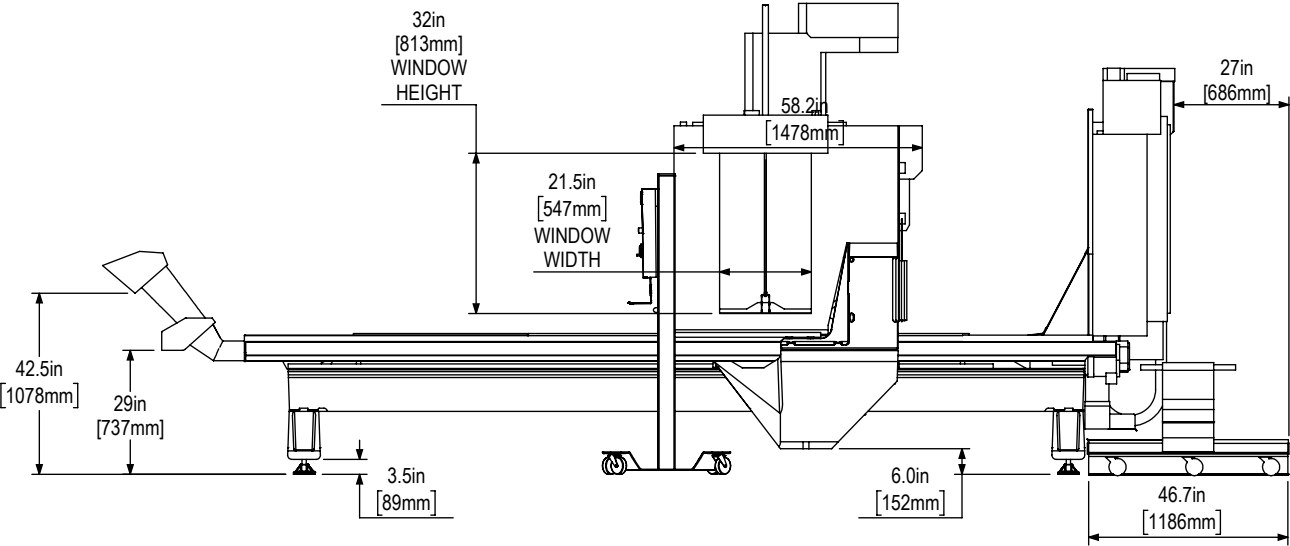

TOP VIEW

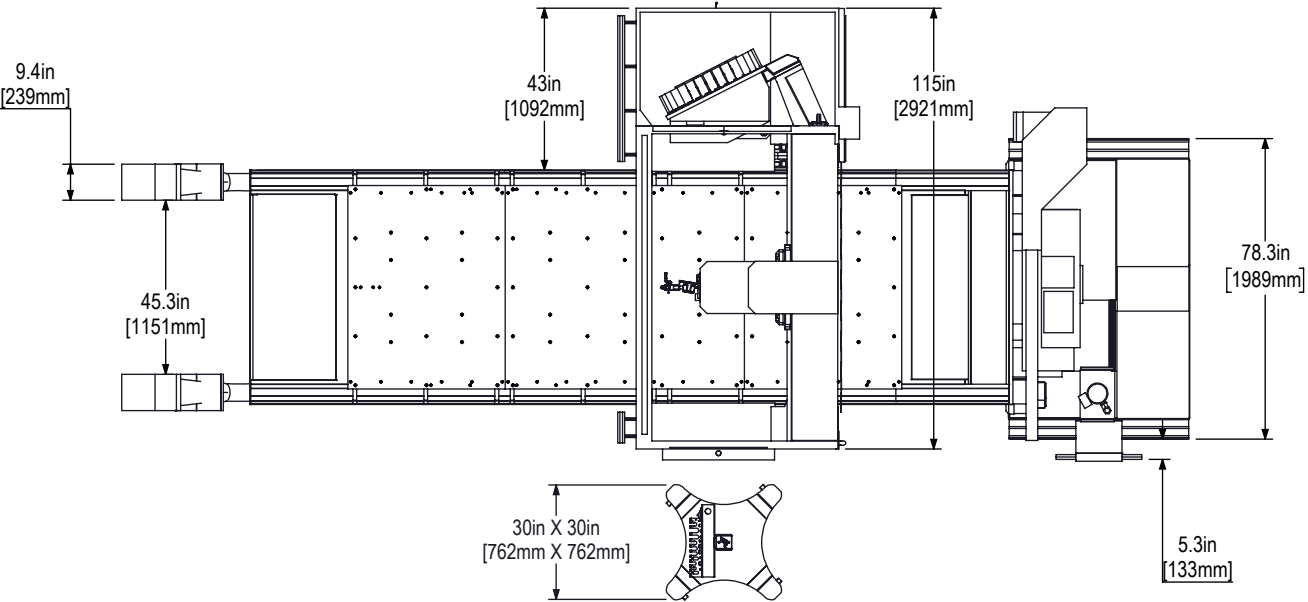

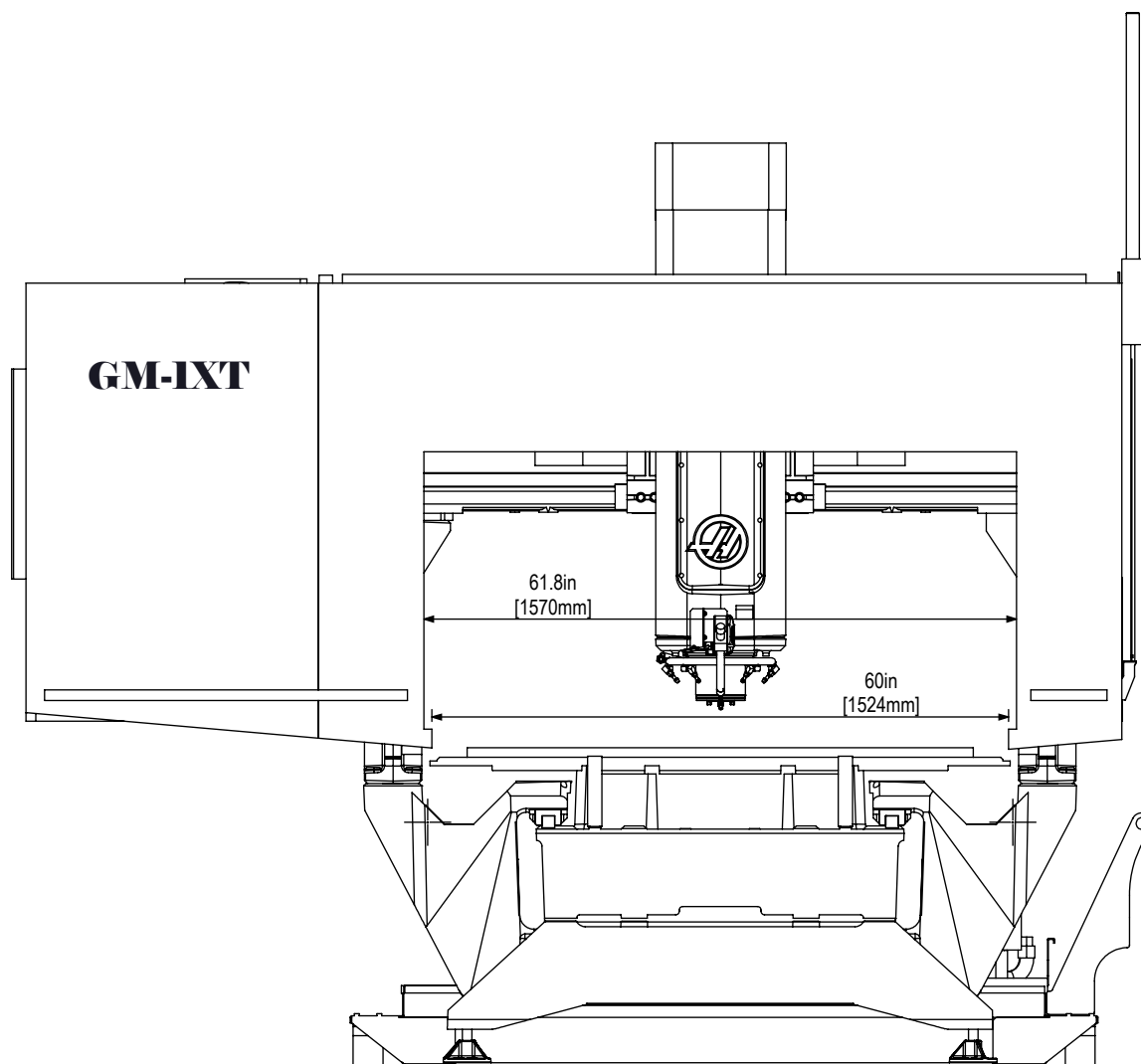

IF THE PART IS RAISED 2.5 INCHES (63.5MM) FROM THE
TABLE TOP, A PART MEASURING 61.8 INCHES (1570mm)
WIDE, MAY BE CLEARED THRU THE COLUMNS.



RIGHT SIDE VIEW
ELECTRICAL CABINET SIDE

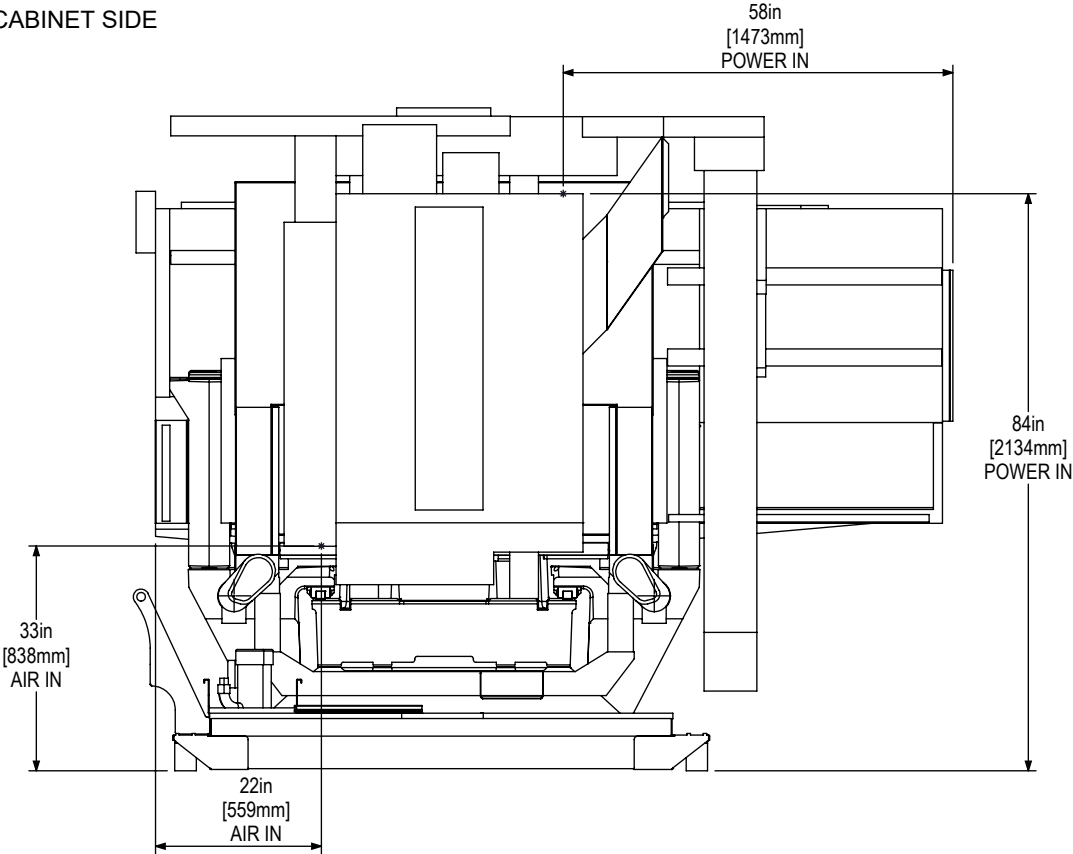

MACHINE MUST BE PLACED ON A SINGLE
CONTINUOUS CONCRETE SLAB.
SLAB MUST EXTEND 12in [305mm]
BEYOND LEVELING PAD LOCATIONS IN
ALL DIRECTIONS

BOTTOM VIEW - ANCHORING NOT REQUIRED

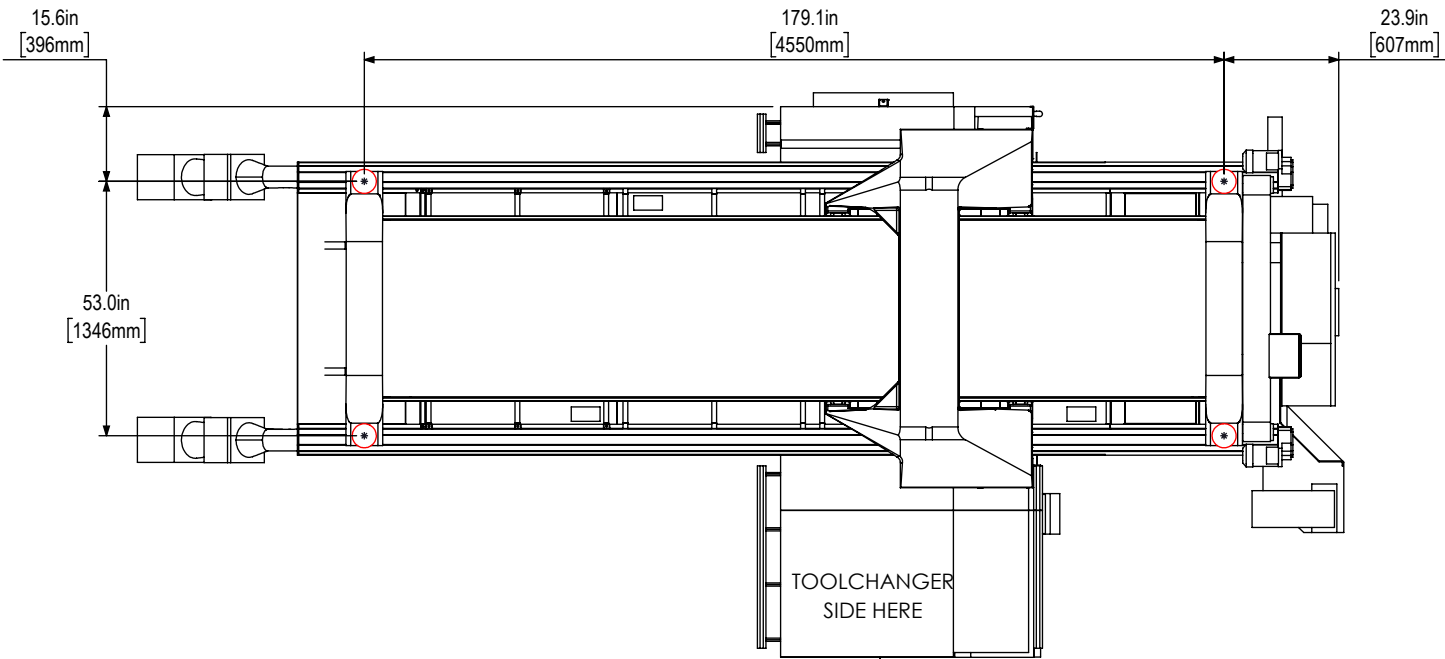

X & Y Axis Clearance

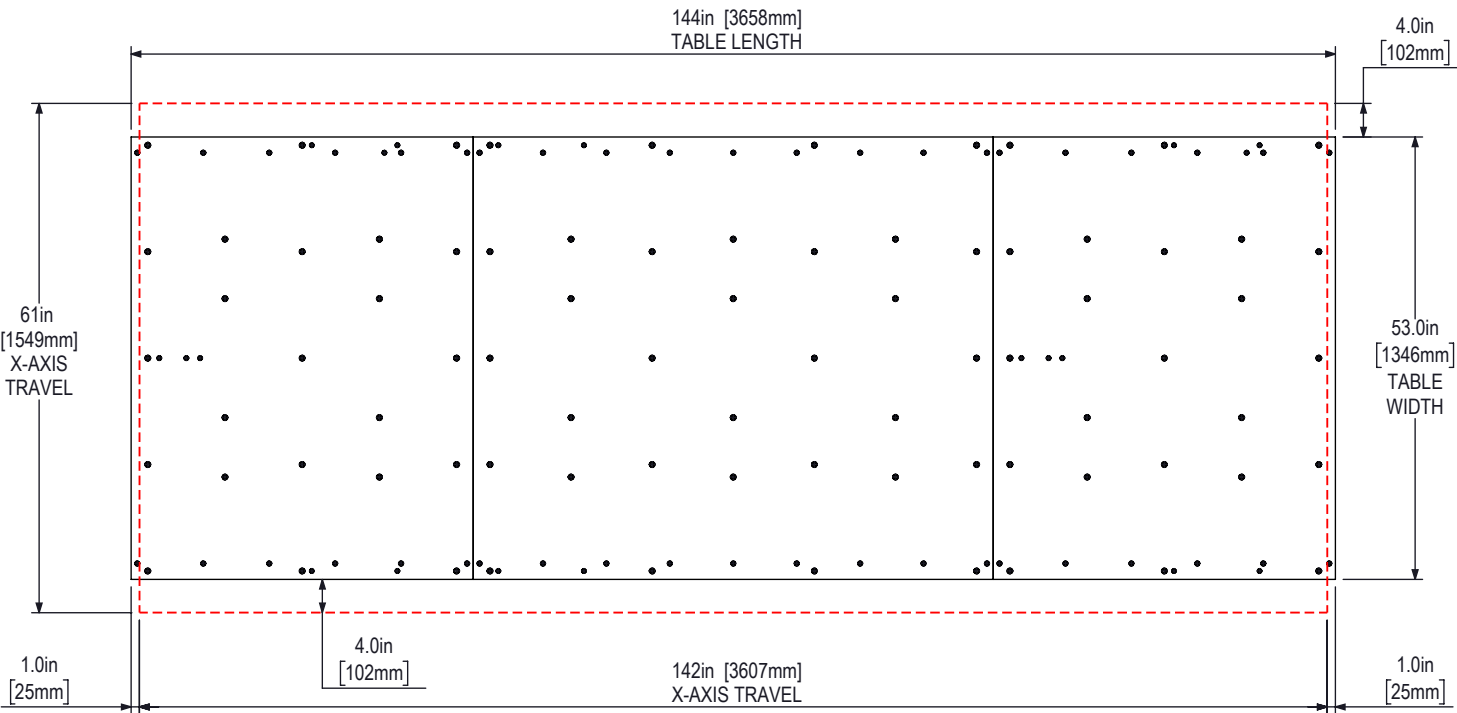

X AND Y HOME ZERO IS BOTTOM RIGHT CORNER OF TRAVEL BOX

Z Axis Travels

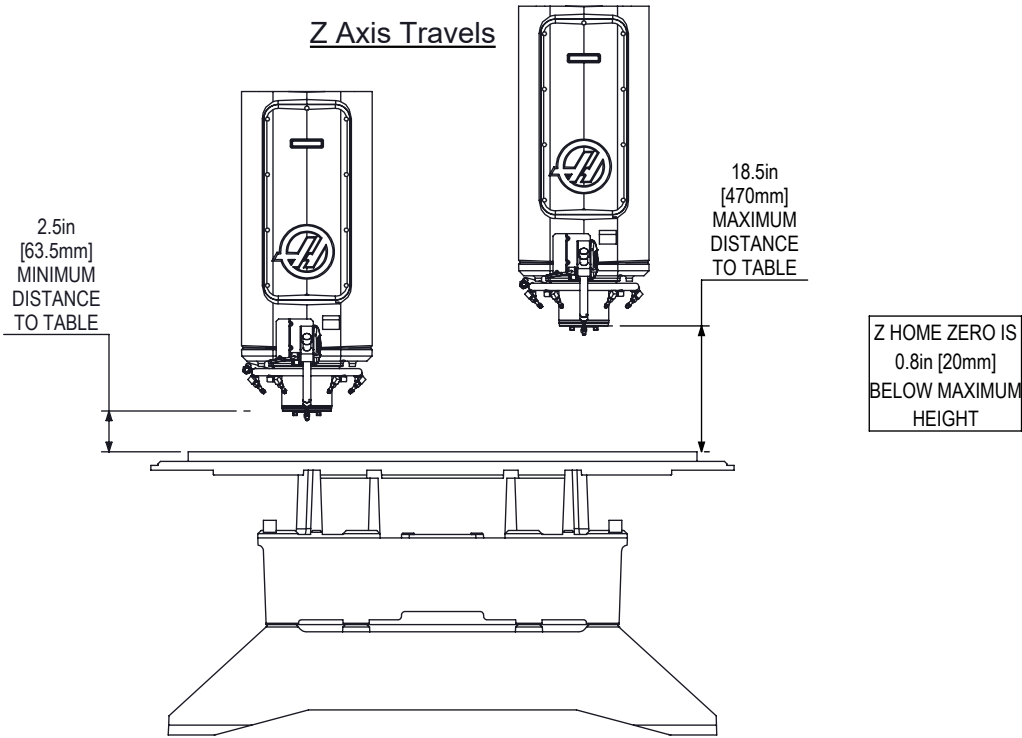

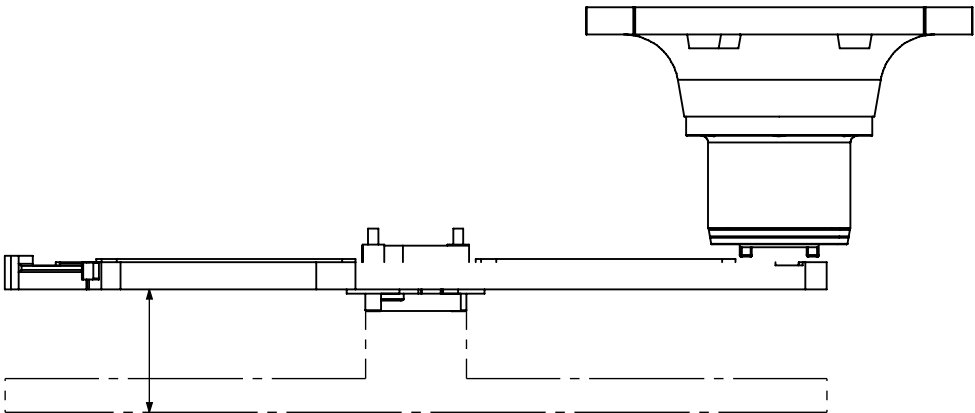

4.5in
[114mm]
DROP DISTANCE
DURING TOOL CHANGE

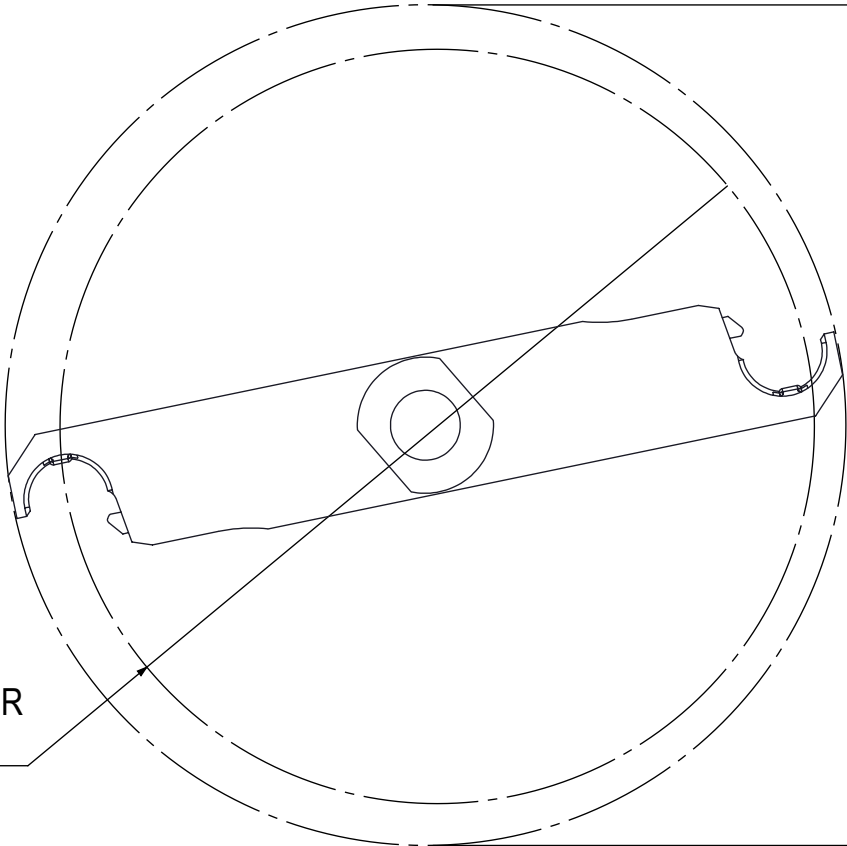

21.6in
[549mm]
SWING DIAMETER
AT SPINDLE

24.4in
[620mm]
TOOL CHANGE
ARM SWING

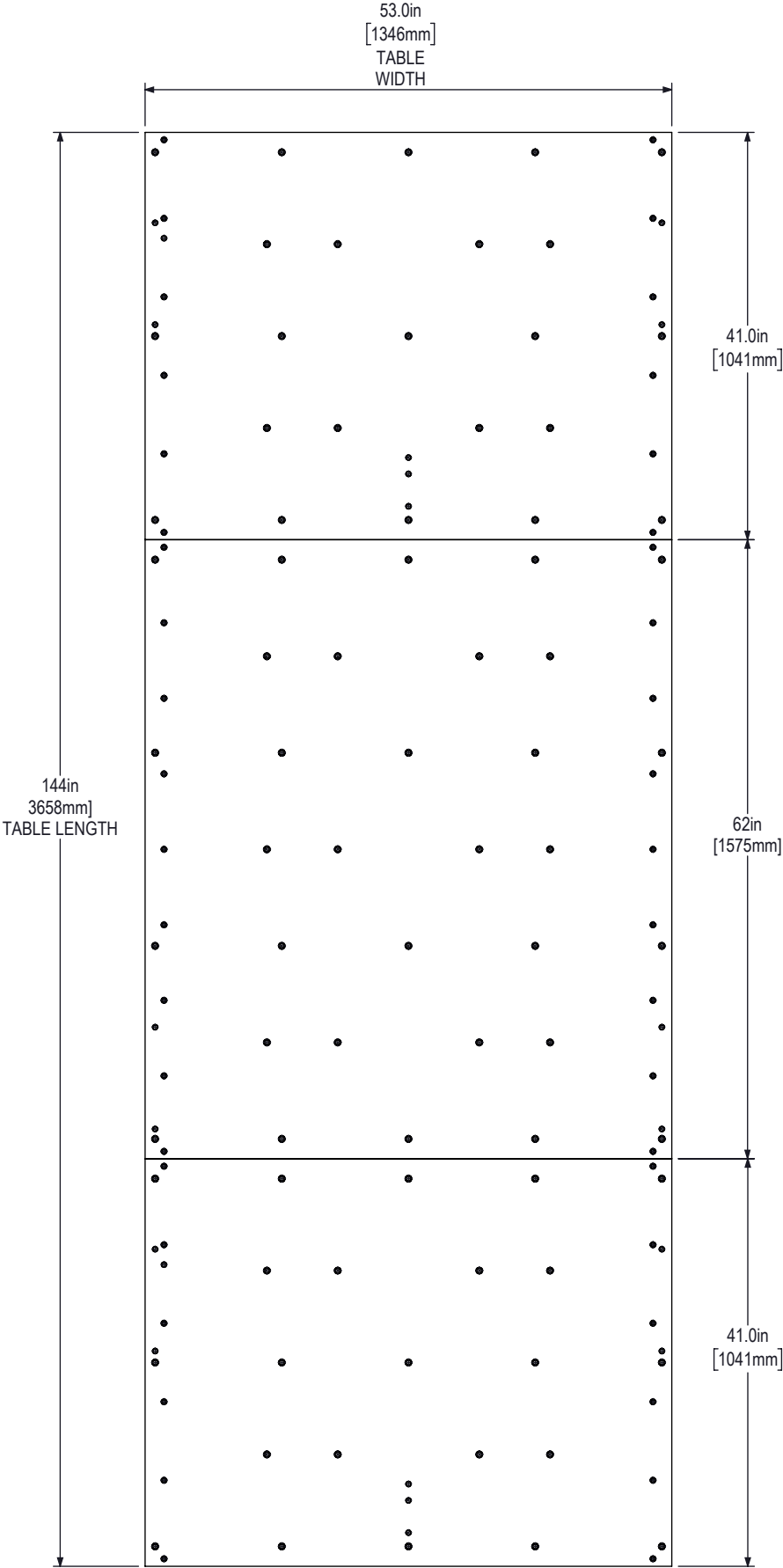

TABLE HAS 3
SECTIONS TOTAL

TABLE THICKNESS
1in [25.4mm]

DRILL AND TAP
AS NEEDED FOR
CUSTOM
WORKHOLDING

**DO NOT
DRILL THRU**

THERE ARE NO
HOLE LOCATION
LIMITATIONS

EXISTING HOLES
ARE NOT AVAILABLE
FOR WORKHOLDING