

2X $\varnothing .42\text{in}$ [10.7mm] $\nabla .75\text{in}$ [19.1mm]
1/2-13 UNC - 2B $\nabla .67\text{in}$ [17.1mm]

2X $\varnothing .500\text{in}^{+.001}_{-.000}$ [$12.7\text{mm}^{+0.025}_{0.000}$] $\nabla .500\text{in}$ [12.7mm]
Dowel Pin Holes

$\varnothing 12.45\text{in}$ [316.2mm]
Bolt Hole Circle

.62in [15.9mm]
Locating Key

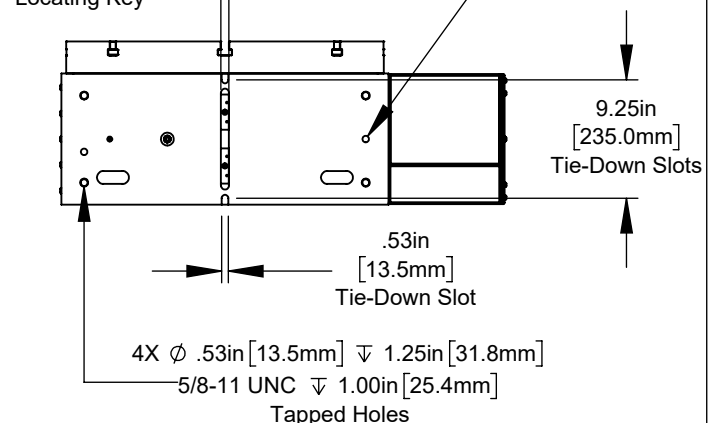
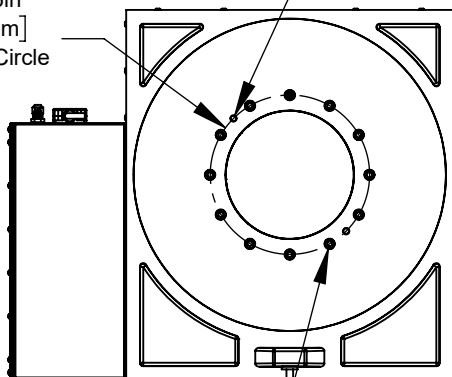

12X 1/2-13 UNC - 2B THRU

All dimensions based on stackup of sheetmetal, subject to variation of 1/2" (13 mm)

*Due to continual product improvements, machine dimensions are subject to change without notice.

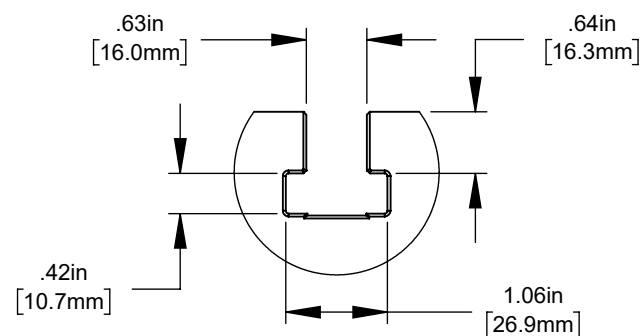
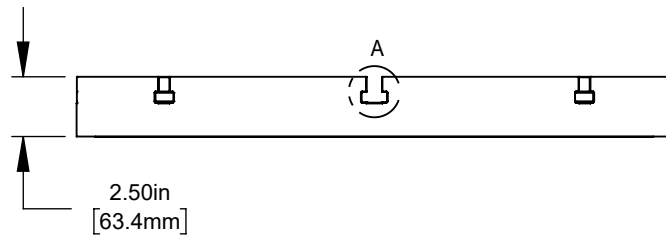
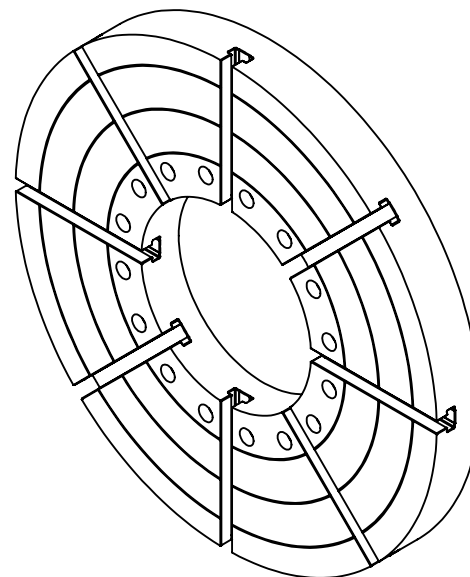
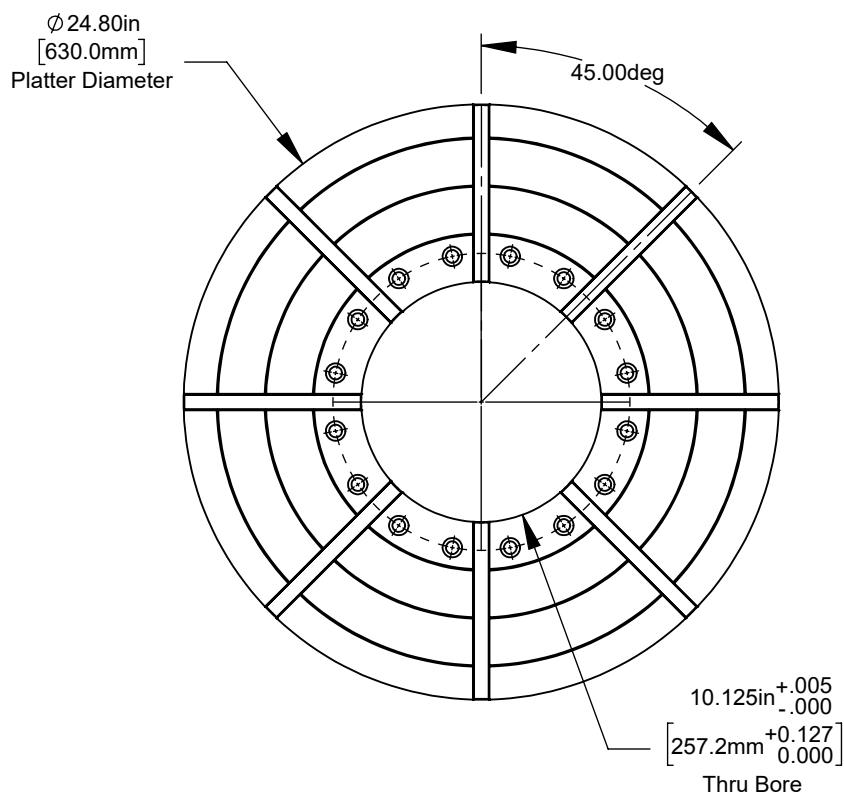

DETAIL A
SCALE 1 : 2